



MADE IN GERMANY



UNDERGROUND TECHNOLOGIES

MINING



BETEK TUNGSTEN CARBIDE TOOLS



UNDERGROUND
TECHNOLOGIES

- FOUNDATION DRILLING
- MINING
- TRENCHLESS
- TRENCHING
- TUNGSTUDS
- DRUM CUTTERS

IN USE WORLDWIDE

TUNGSTEN CARBIDE AND STEEL

Steel and carbide are two materials with totally different expansion coefficients when subjected to heat. Nevertheless, it is of steel and tungsten carbide that our tools are made, with tungsten carbide for the wear-resistant tip, and steel for the tool shank. Since tools reach high temperatures during use, extreme tensile stresses are generated. These stresses are absorbed by a special brazing material that joins the tungsten carbide tip to the steel section.

We have developed our own methods and systems for this brazing process, which is carried out on fully automated machines with the process covered in an inert protective gas. Manufacturing parameters are fully monitored and documented to ensure consistent quality. Afterwards, brazing shear strengths are checked to ensure that our "Masters of the construction site" lose no time due to broken tools!



BETEK HIGH-TECH TOOLS



1

CUSTOMER SERVICE

- Efficient, customised solutions based on flexible structures
- Personalised, quick response to customer requirements



2

DEVELOPMENT & CONSTRUCTION

- Quick creation of samples and prototypes
- Competitive pricing thanks to close cooperation with all production units



3

TUNGSTEN CARBIDE MANUFACTURING

- High-purity raw materials are used for high strength
- Consistently high, pore-free tungsten carbide quality through precise process control thanks to years of experience and know-how



4

SOLDERING PRODUCTION UNIT

Production facilities and processes specially developed to perfection by experts in the combination of tungsten carbide and steel



5

AUTOMATION

Maintaining a competitive edge on the global market thanks to a high degree of automation and flexible manufacturing facilities



6

QUALITY ASSURANCE

Continuous quality testing of the entire manufacturing chain all the way up to the installation site, in conformity with DIN ISO 9001:2000 and DIN EN ISO 14001



7

TRAINING

User training courses at BETEK or on-site for sustainable, long-term commercial success and customer satisfaction



8

LOGISTICS

Quick responses thanks to:

- the use of the very latest IT and enhanced logistics networking
- Standard products kept in stock

OUR KNOW-HOW COMBINED WITH STATE-OF-THE-ART PRODUCTION TECHNOLOGIES GUARANTEES THE FINEST QUALITY, MADE IN GERMANY



ROUND SHANK CUTTER BITS

► SHANK SYSTEM – Ø 25 MM/1"

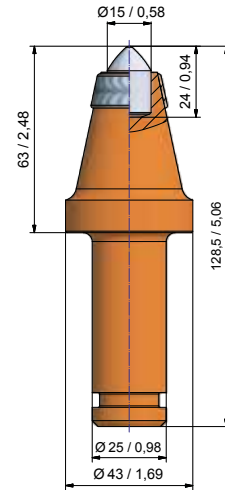
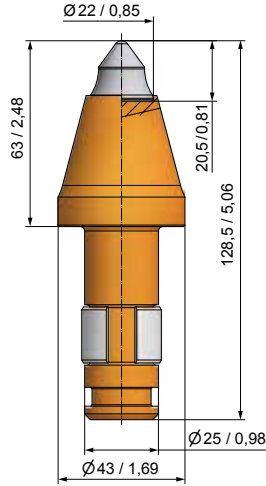
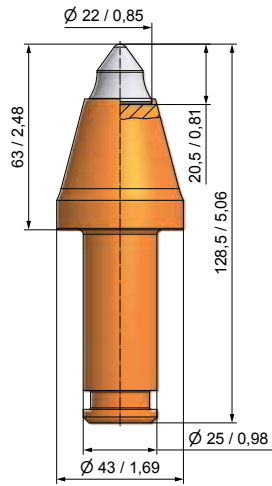
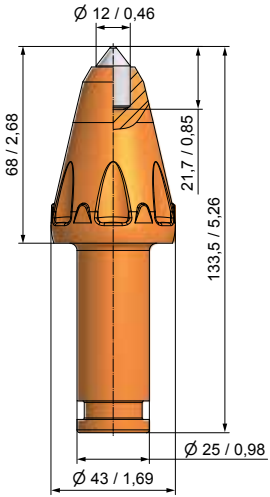

■ **BTK140**
BG25P-12.4368

■ **BTK107**
BG25P-74.4363

■ **BTK107-DUAL**
BG25HP-74.4363

■ **BTK138P**
BG25P-15.4363P

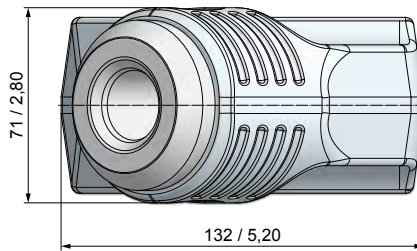
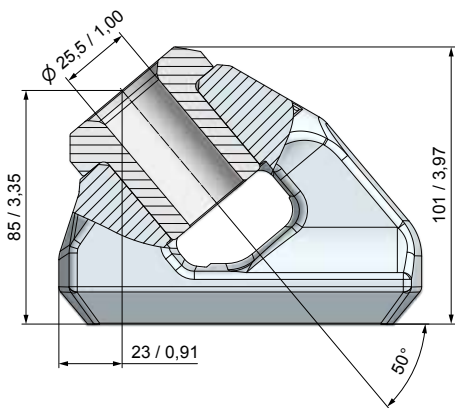

■ **BHR185**
B132-101-B

ROUND SHANK CUTTER BITS



▶ SHANK SYSTEM – Ø 30 MM/1,18"

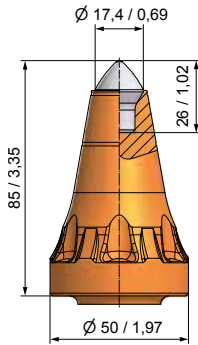

■ **BGF27**
BG30P-70.5085

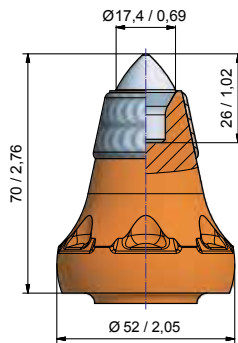

■ **BGF28P**
BG30P-70.5070P

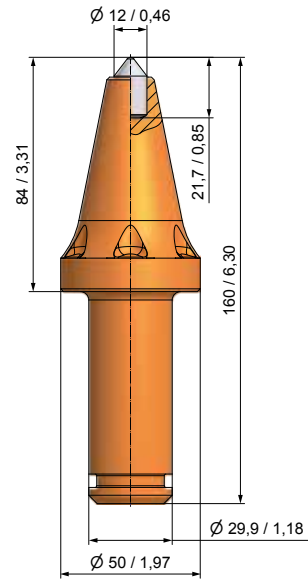

■ **BGF21**
BG30P-12.5084

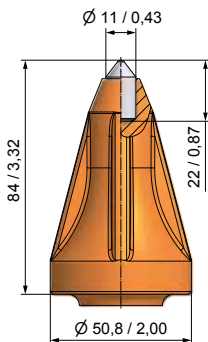

■ **BGF14**
BG30P-11.5184F

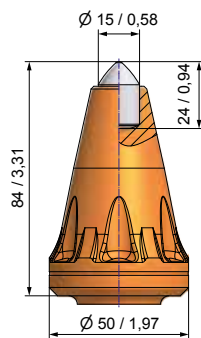

■ **BGF29**
BG30P-15.5084

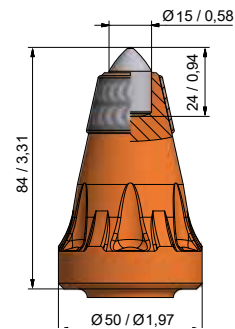

■ **BGF29P**
BG30P-15.5084P



► SHANK SYSTEM – Ø 30 MM/1,18"

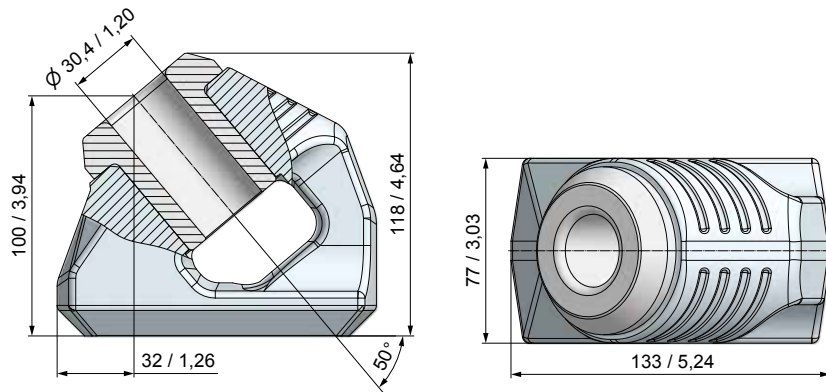

■ BHR183
B133-118-B



ROUND SHANK CUTTER BITS

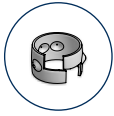

▶ SHANK SYSTEM – Ø 30 MM/1,18" SHANK 82MM/3,2"

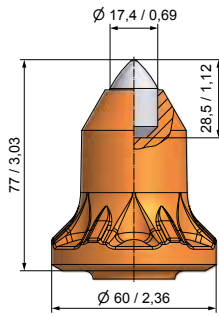

• **BGK86**
BG30K-17.6077

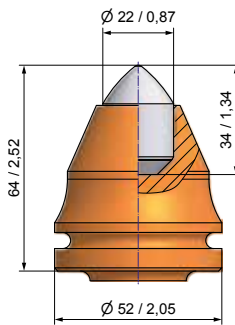

• **BGK38**
BG30K-22.5264

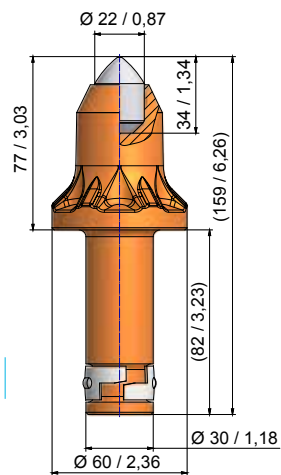

• **BGK90**
BG30K-22.60.77

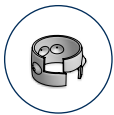

▶ SHANK SYSTEM – Ø 30 MM/1,18" SHANK 96MM/38"

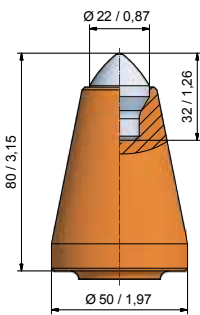

• **BGK108**
BG30K-73.5080

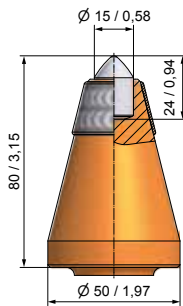

• **BGK100P**
BG30K-15.5080P

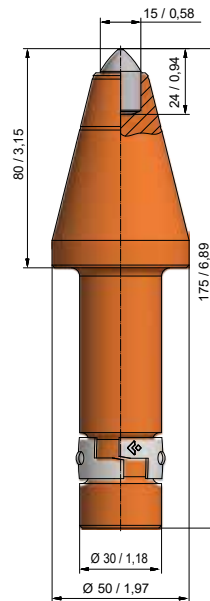

• **BGK100**
BG30K-15.5080



► SHANK SYSTEM – Ø 30 MM/1,18"
SHANK 76MM/3"

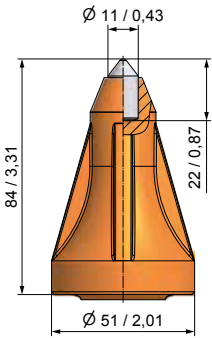
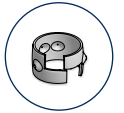

■ **BGK99**
BG30K-11.5184F

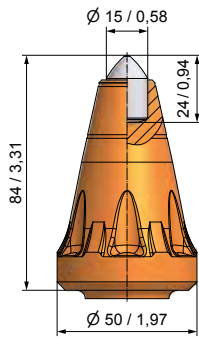

■ **BGK97**
BG30K-15.5084

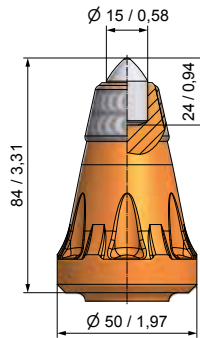

■ **BGK97/P**
BG30K-15.084P

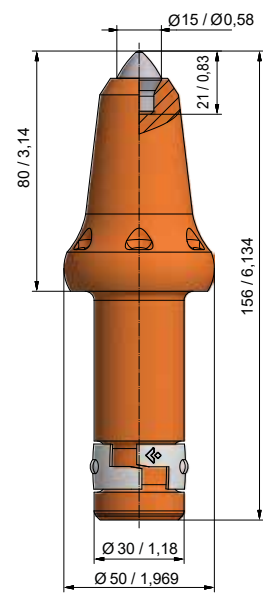

■ **BGK110**
BG30K-76.5080

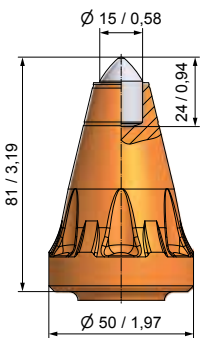

■ **BGK84**
BG30K-15.5081

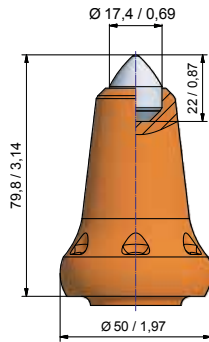

■ **BGK109**
BG30K-17.5080

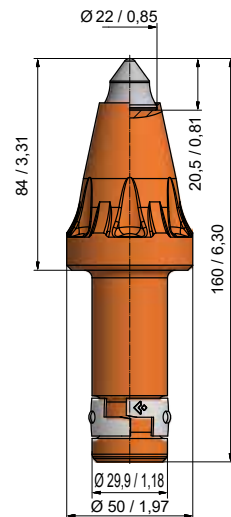

■ **BGK105**
BG30K-74.5084





ROUND SHANK CUTTER BITS

► SHANK SYSTEM – Ø 30 MM/1,18"

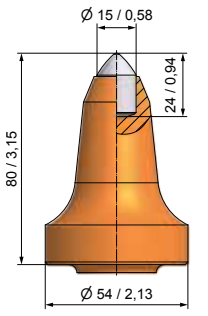

■ **BGS95**
BG30W-15.5480

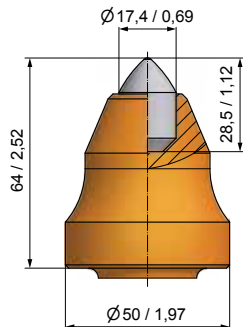

■ **BGS17**
BG30W-17.5064

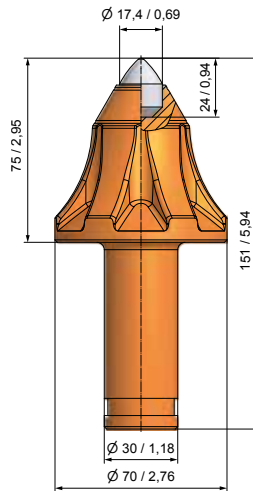

■ **BGS89**
BG30W-17.7075

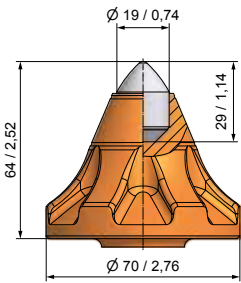

■ **BGS88**
BG30W-19.7064

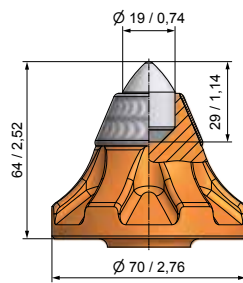

■ **BGS84P**
BG30W-19.7064P

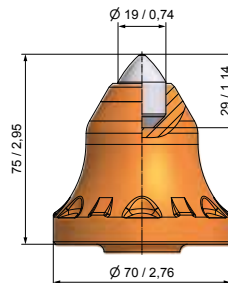

■ **BGS100**
BG30W-19.7075

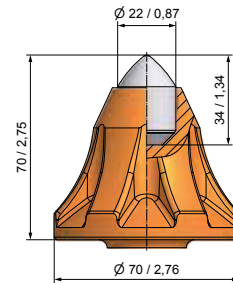

■ **BGS90**
BG30W-22.7070

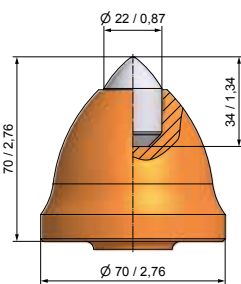

■ **BGS93**
B47GK22LK70/70

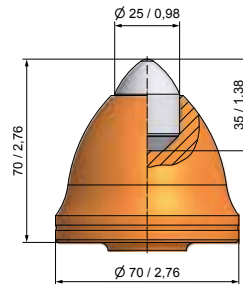

■ **BGS16**
BG30W-25.7070A

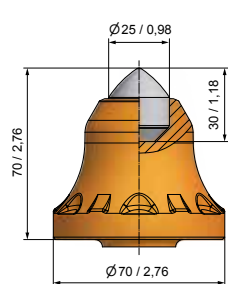

■ **BGS105**
BG30W-25.7070

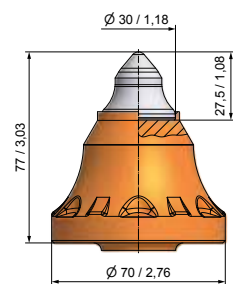

■ **BGS103**
BG30W-69.7077



ROUND SHANK CUTTER BITS



> SHANK SYSTEM – Ø 30 MM/1,18"

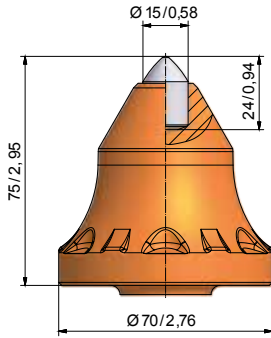

■ **BGF25**
BG30F-15.7075 

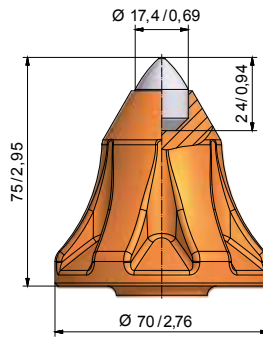

■ **BGF10**
BG30F-17.7075 

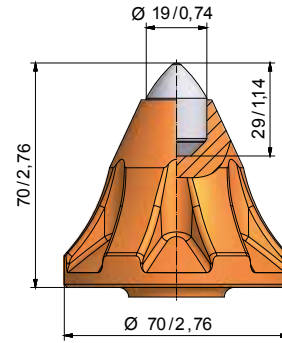

■ **BGF36**
BG30F-19.7070 

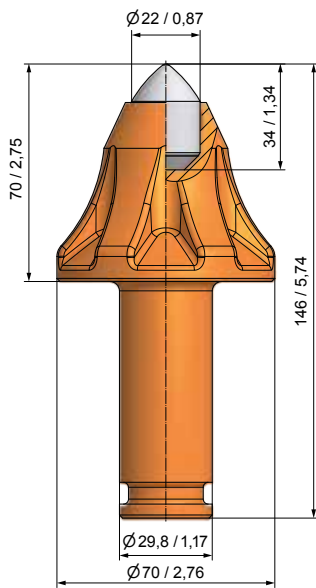

■ **BGF11**
BG30F-22.7070 

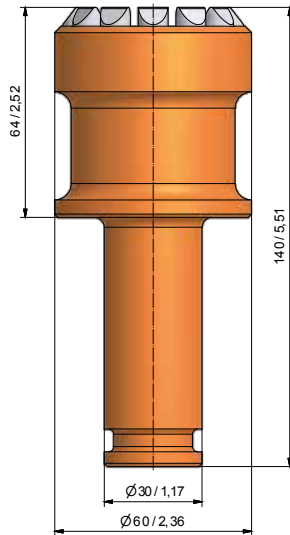

■ **BSR58**
BG30F-09.6064 

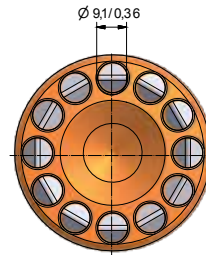

► SHANK SYSTEM – Ø 30 MM/1,18"

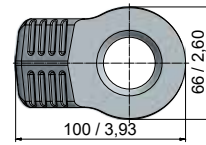
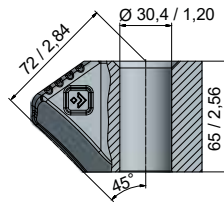
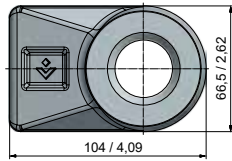
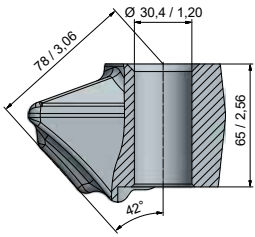

▪ BHR35
B30.65



▪ BHR94
B43G

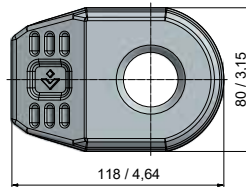
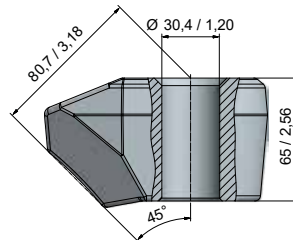
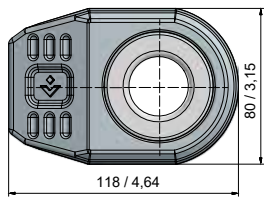
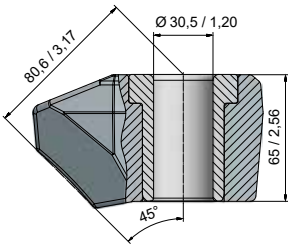

▪ BHR75
B30.65H



▪ BHR193
B30.8045

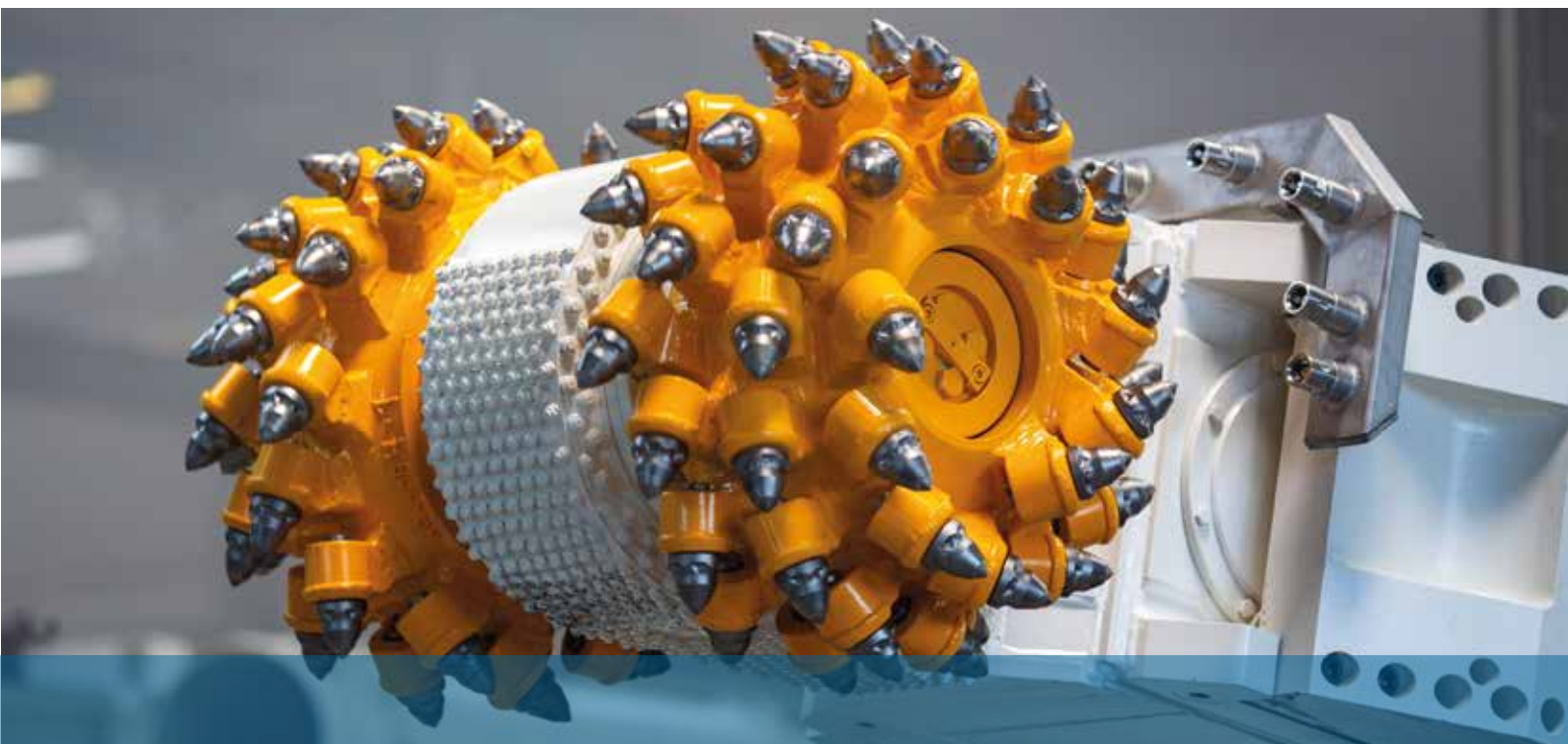

ROUND SHANK CUTTER BITS



▶ SHANK SYSTEM – Ø 32 MM/1,26"

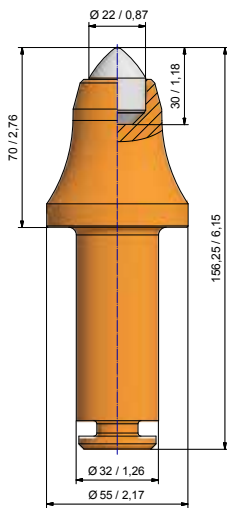

• **BSR295**
BG32FL-22.5570

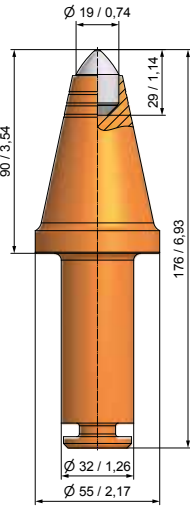

• **BSR303**
BG32FL-19.5590

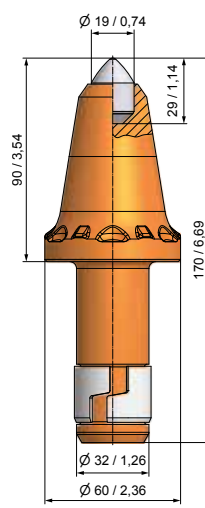

• **BSR271**
BG32H-19.6090

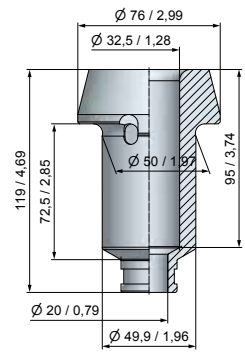

• **BR89**
BR50-32/K



▶ SHANK SYSTEM – Ø 32/33 MM – 1,26/1,3"

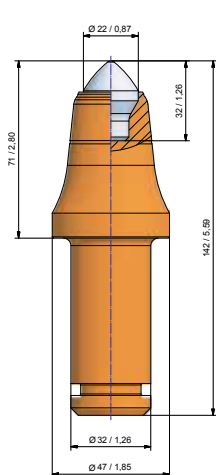

• **BSR332**
BG32P-73.4771
Holder length 58 mm

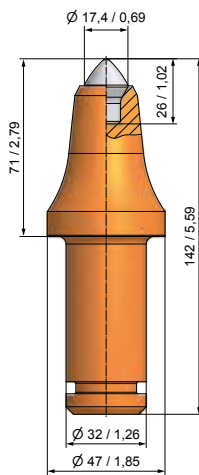

• **BSR245**
BG32P-70.4771
Holder length 58 mm

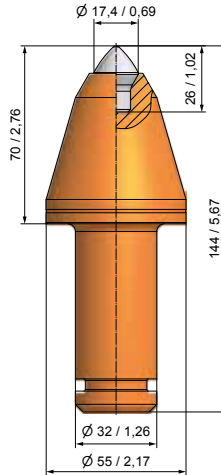

• **BSR269**
BG32P-70.55.70C
Holder length 61 mm

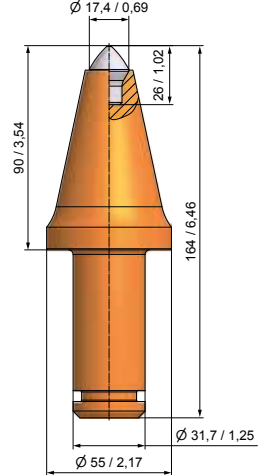

• **BSR255**
BG32P-70.5590A
Holder length 62 mm





► SHANK SYSTEM – Ø 32/33 MM – 1,26/1,3"

Holder length 63 mm

Holder length 64 mm

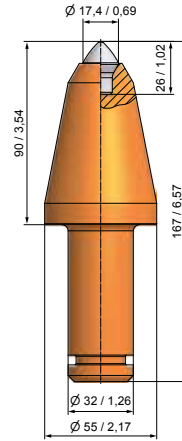
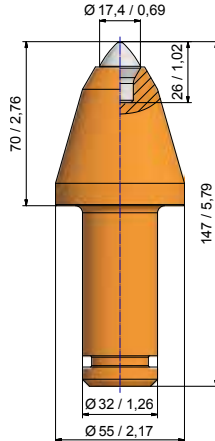
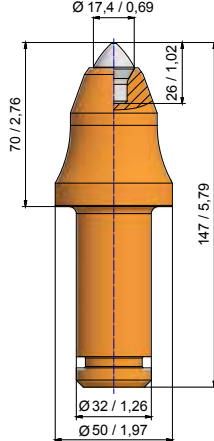
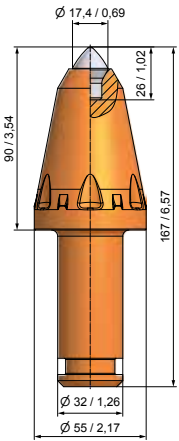

■ **BSR290**
BG32P-70.5590A



■ **BSR248/2**
BG32P-70.5070



■ **BSR251**
BG32P-70.5570A



■ **BSR279**
BG32P-70.5590



Holder length 67 mm

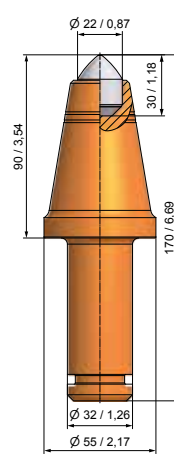
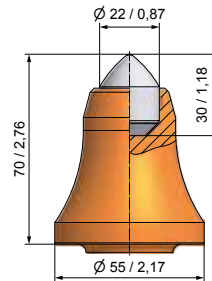
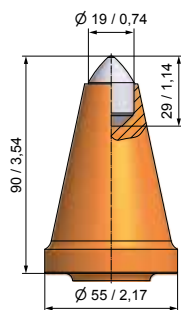
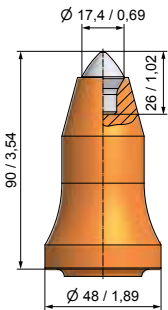

■ **BSR234**
BG32P-70.4890



■ **BSR281**
BG32P-19.5590A



■ **BSR262**
BG32P-22.5570A



■ **BSR294**
BG32P-22.5590A

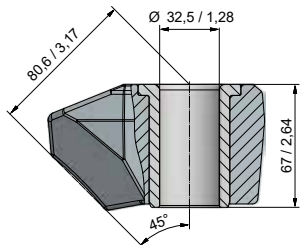

■ **BHR205**
B32.67H

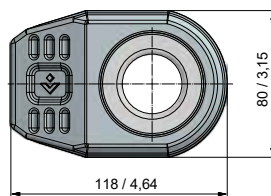

ROUND SHANK CUTTER BITS



> SHANK SYSTEM – Ø 32/33 MM – 1,26/1,3" ---

Holder length 72 mm

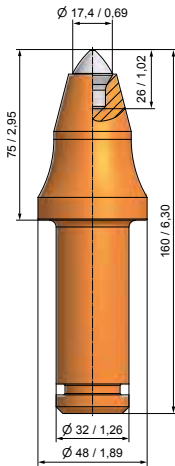

• **BSR165**
BG32P-70.4875



Holder length 74 mm

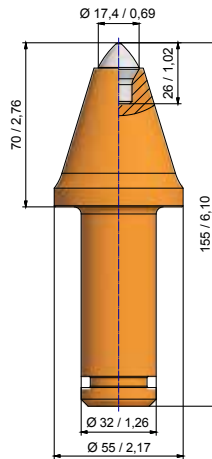

• **BSR241**
BG32P-70.5570



Holder length 74 mm

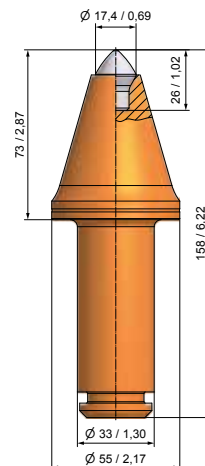

• **BSR242**
BG33P-70.5573



► SHANK SYSTEM – Ø 32/33 MM – 1,26/1,3"



Holder length 75 mm

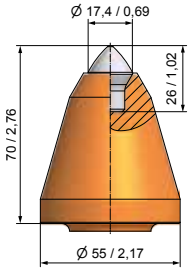

■ **BSR252**
BG32P-70.5570B

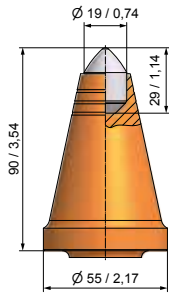

■ **BSR270/2**
BG32P-19.5590A

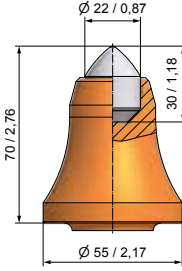

■ **BSR246/3**
BG32P-22.5570

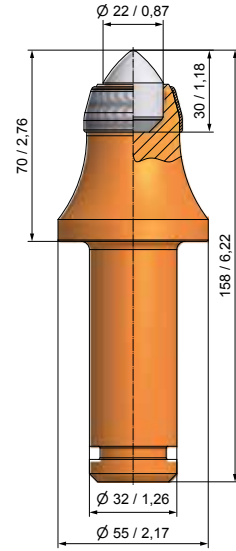

■ **BSR274P**
BG33P-22.5570P

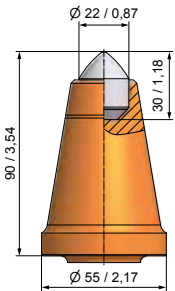

■ **BSR282**
BG32P-22.5590

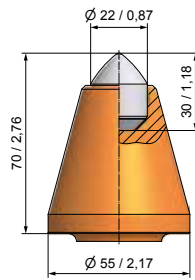

■ **BSR263**
BG33P-22.5570

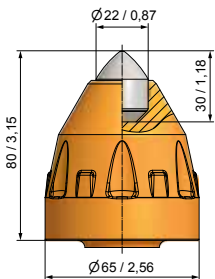

■ **BSR333**
BG31P-22.6580

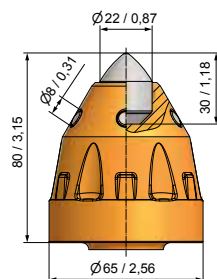

■ **BSR334**
BG31P-22.6580SE

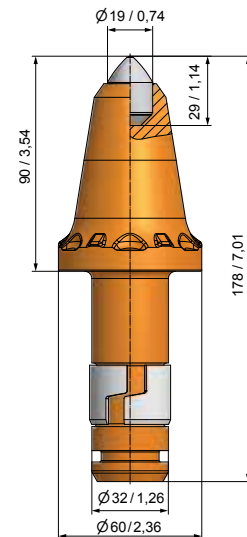

■ **BSR330**
BG32HP-19.6090



ROUND SHANK CUTTER BITS

► SHANK SYSTEM – Ø 32/33 MM – 1,26/1,3" ---

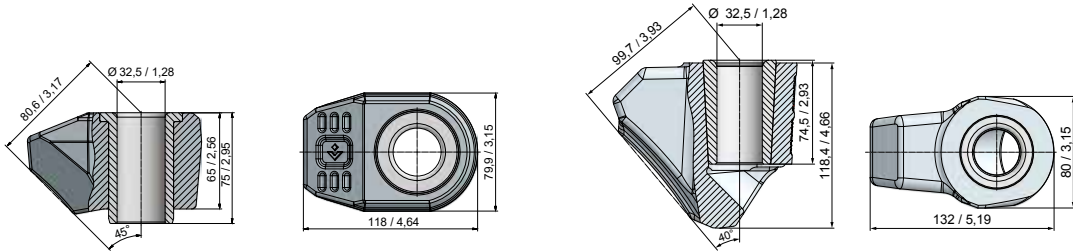

• **BHR224**
B32.75H 

• **BHR242**
B33.8040 

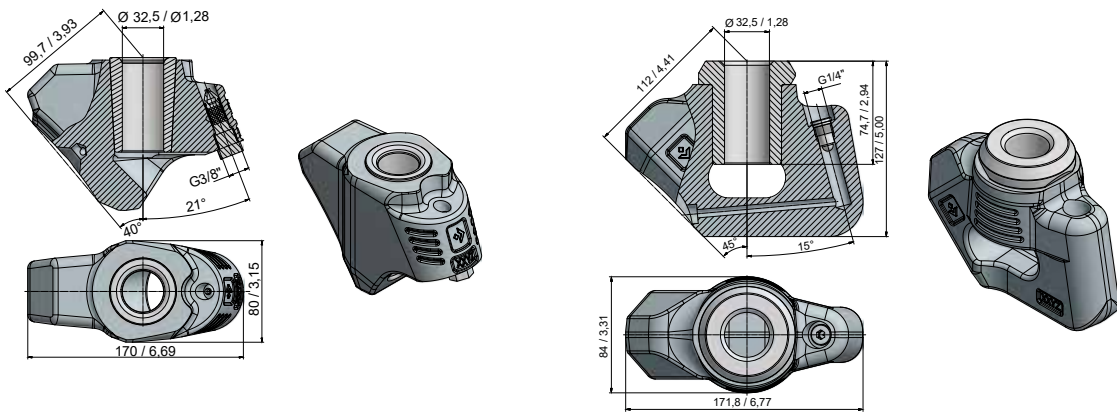

• **BHR243**
B33.8040-B 

• **BHR213**
B32.8445-B 



► SHANK SYTEM – Ø 35 MM/1,38"

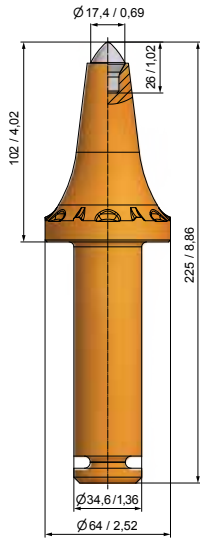
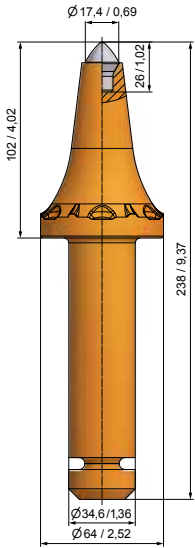

• **BSR346**
BG35X-70.64102



• **BSR347**
BG35X-70.64102A

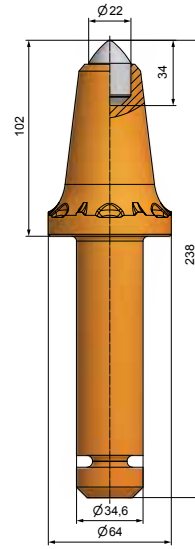
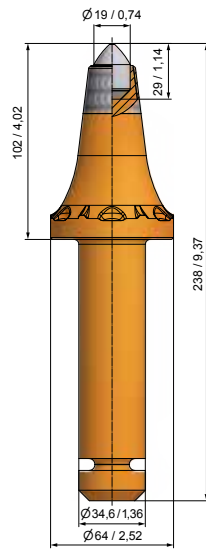
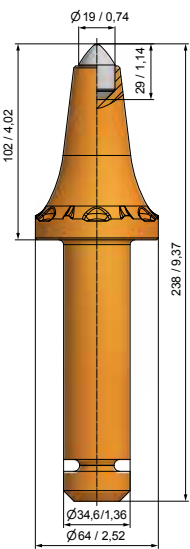

• **BSR343**
BG35X-19.64102



• **BSR343P**
BG35X-19.64102P



• **BSR324**
BG35X-22.64102



ROUND SHANK CUTTER BITS



> SHANK SYSTEM – Ø 35 MM/1,38" GAUGE 89 MM/3,5"

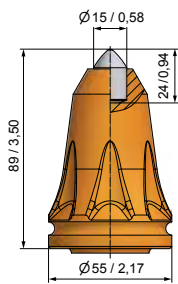

• **BSR370**
BG35H-15.5589

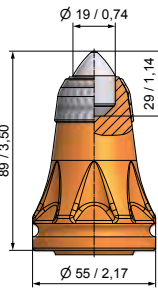

• **BSR111P**
BG35H-19.5589AP

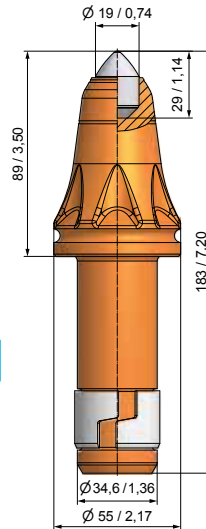

• **BSR111**
BG35H-19.5589A

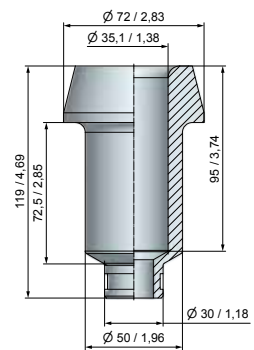

• **BR71**
BR49.8-35-119

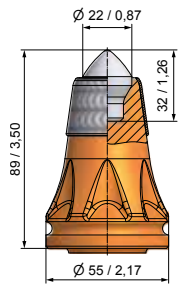

• **BSR285P**
BG35H-73.5589P

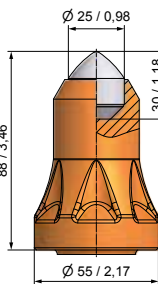

• **BSR228**
BG35H-25.5588

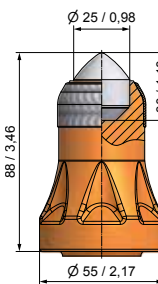

• **BSR288P**
BG35H-25.5588P

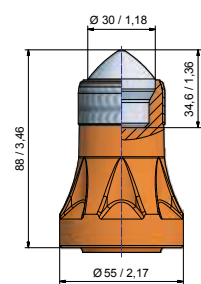

• **BSR445P**
BG35H-30.5588P



► SHANK SYSTEM – Ø 35 MM/1,38"
GAUGE 89 MM/3,5"

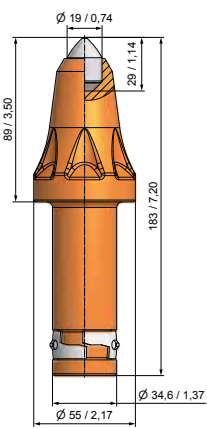
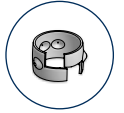

• BSR112

BG35K-19.5589

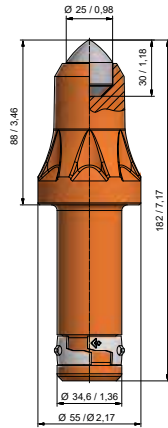

• BSR259

BG35K-25.5588

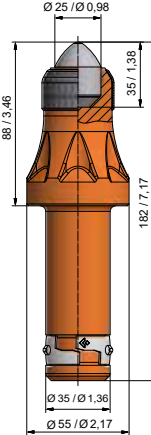

• BSR451P

BG35K-25.5588P



► SHANK SYSTEM – Ø 35 MM/1,38"
GAUGE 100–102 MM/4"

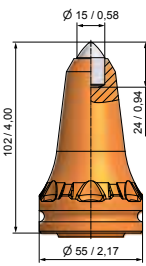
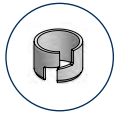

• BSR221

BG35H-15.55102A

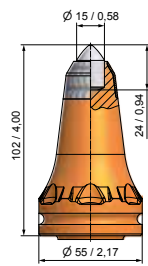

• BSR224P

BG35H-15.55102P

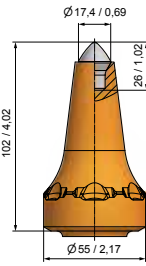

• BSR319

BG35H-70.55102A

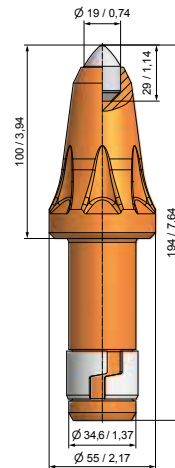

• BSR175

BG35H-19.55100

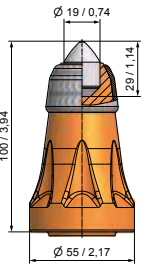

• BSR146P

BG35H-19.55100PA

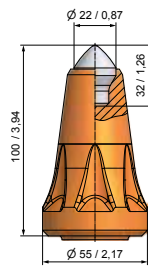

• BSR249

BG35H-73.55100

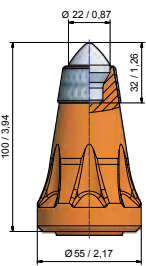

• BSR249P

BG35H-73.55100P



ROUND SHANK CUTTER BITS



> SHANK SYSTEM – Ø 35 MM/1,38"
GAUGE 100–102 MM/4"

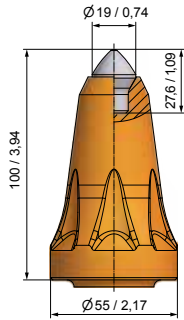

• BSR362
BG35K-72.55100

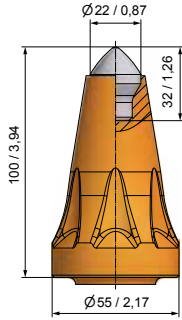

• BSR363
BG35K-73.55100

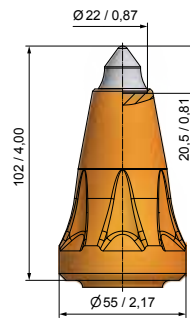

• BSR207
BG35K-74.55102

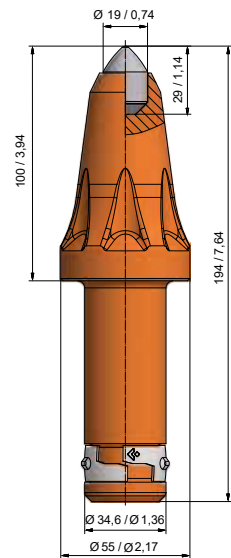

• BSR357
BG35K-19.55100

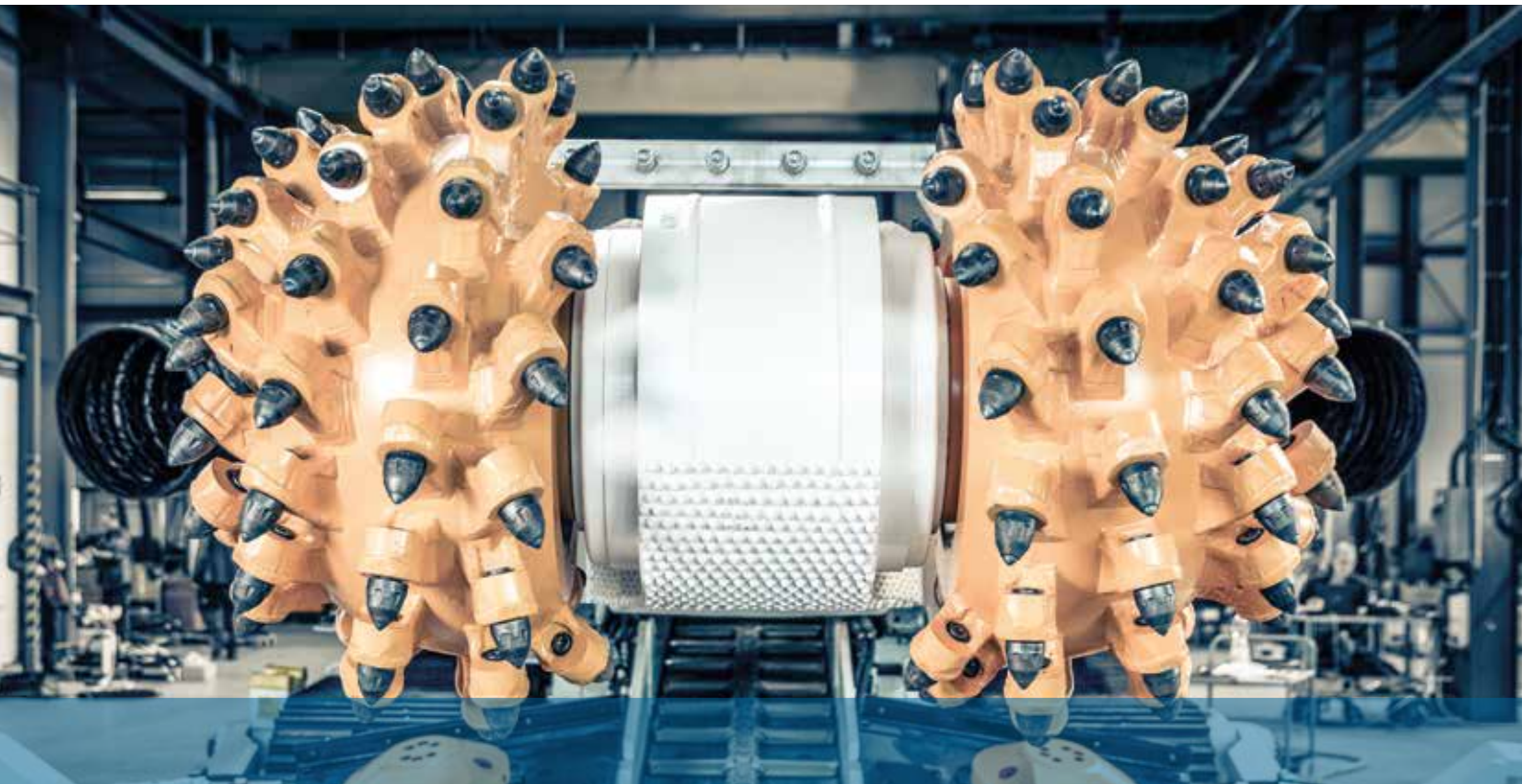

► SHANK SYSTEM – Ø 38/30 MM-1,5/1,18"

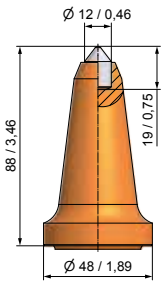

■ **BKS16**
BS38W-12.4888

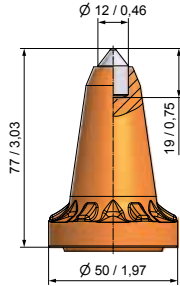

■ **BKS153**
BS38W-12.5077

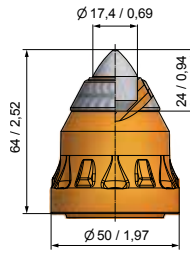

■ **BKS155P**
BS38W-17.5064P

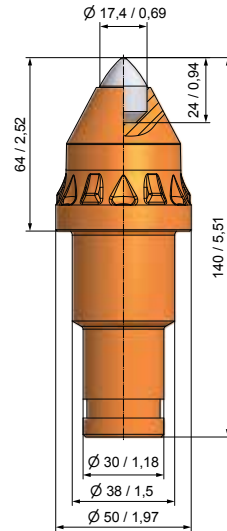

■ **BKS155**
BS38W-17.5064

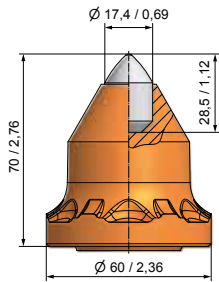

■ **BKS166**
BS38W-17.6070

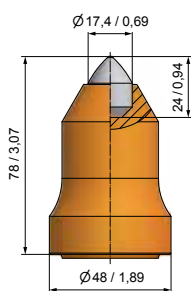

■ **BKS191**
BS38W-17.4878

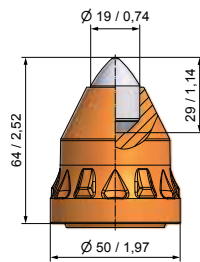

■ **BKS154**
BS38W-19.5064

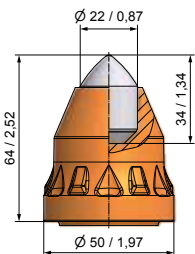

■ **BKS156**
BS38W-22.5064

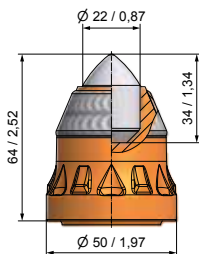

■ **BKS156P**
BS38W-22.5064P

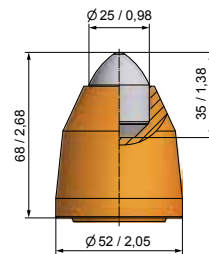

■ **BKS204**
BS38W-25.5268

ROUND SHANK CUTTER BITS



> SHANK SYSTEM – Ø 38/30 MM-1,5/1,18"

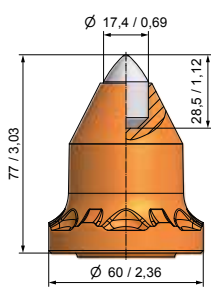

• **BKS171**
BS38W-17.6077

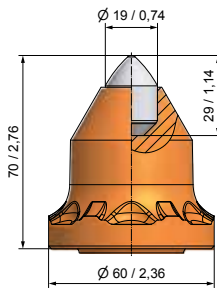

• **BKS189**
BS38W-19.6070

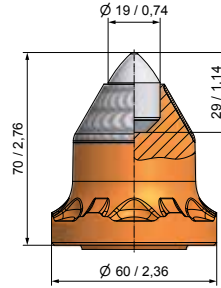

• **BKS190P**
BS38W-19.6070P

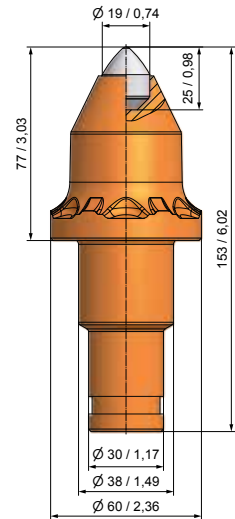

• **BKS172**
BS38W-19.6377



> SHANK SYSTEM – Ø 38/30 MM-1,5/1,18"

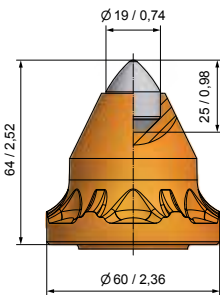

• **BKFL03**
BS38FL-19.6064

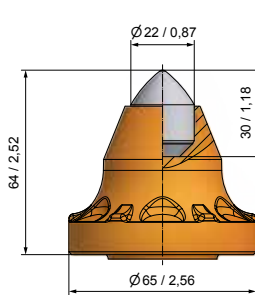

• **BKFL02**
BS38FL-22.6564

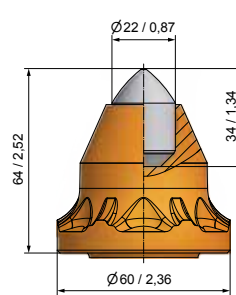

• **BKFL04**
BS38FL-22.6064

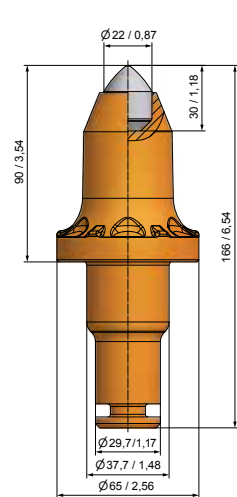

• **BKFL01**
BG35L-22.6590

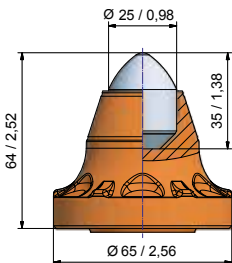

• **BKFL06**
BS38FL-25.6564

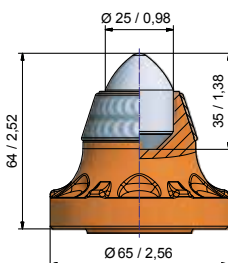

• **BKFL06P**
BS38FL-25.6564P



► SHANK SYSTEM – Ø 38/30 MM-1,5/1,18"

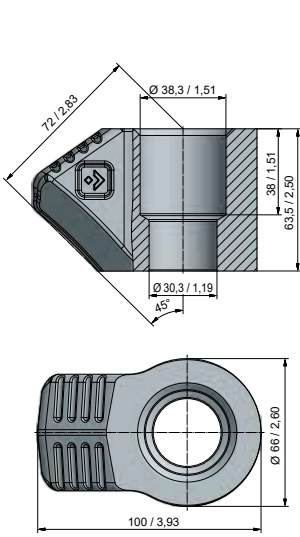

• BHR38
B43H

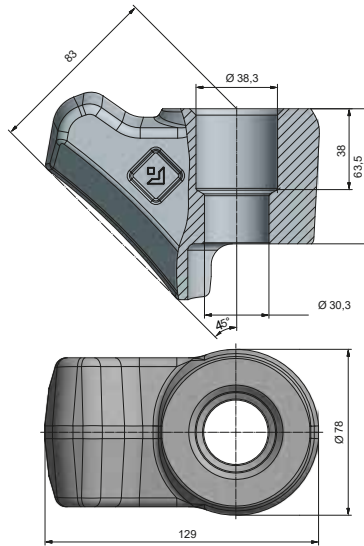

• BHR204
B3830.7845

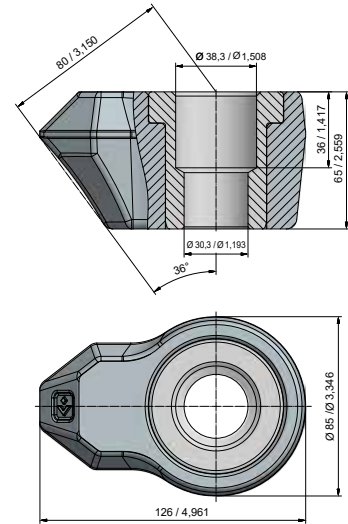

• BHR417
B3830.8536-B



ROUND SHANK CUTTER BITS



▶ SHANK SYSTEM – Ø 38/30 MM-1,5/1,18"

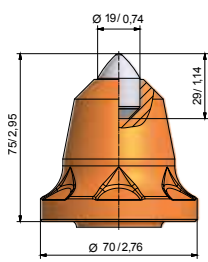

• **BKF15**
BS38W-19.7075

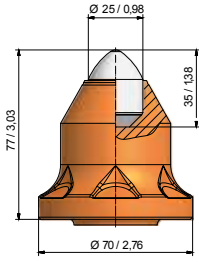

• **BKF10**
BS38W-25.7077

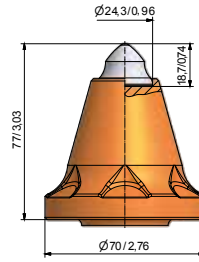

• **BKF16**
B47k24/70-F

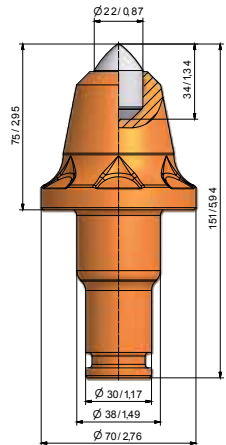

• **BKF17**
B47K22/70-F

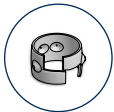

▶ SHANK SYSTEM – Ø 38 MM/1,5"

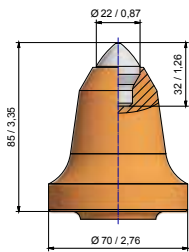

• **BSR455**
BG38K-73.7085

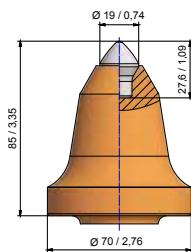

• **BSR456**
BG38K-73.7085

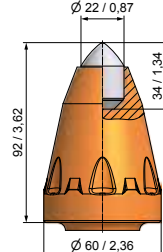

• **BSR297**
BG38K-22.6092

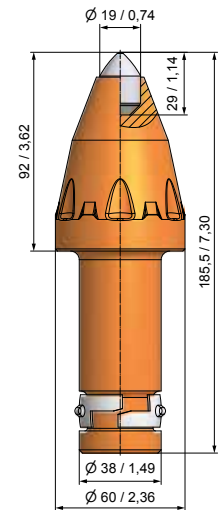

• **BSR296**
BG38K-19.6092

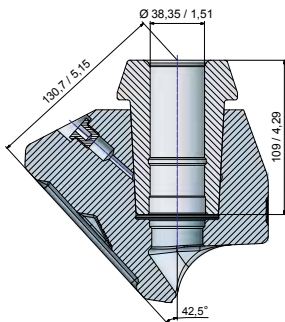

• **BHR288**
B38.10043

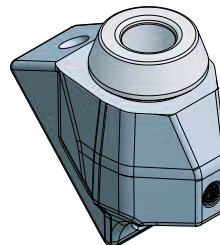
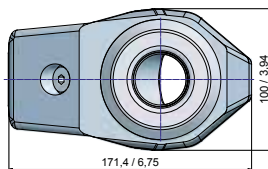

► SHANK SYSTEM – Ø 38/30 MM/1,5"

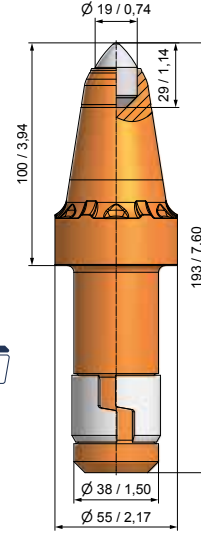
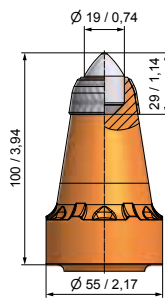
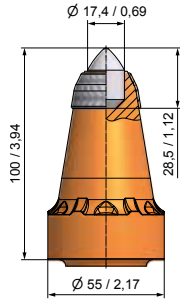
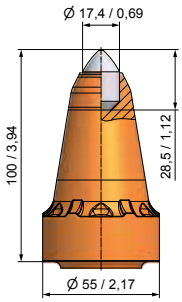

■ **BSR292**
BS38H-17.55100A



■ **BSR292P**
BS38H-17.55100PA



■ **BSR291P**
BS38H-19.55100PA



■ **BSR291**
BS38H-19.55100A

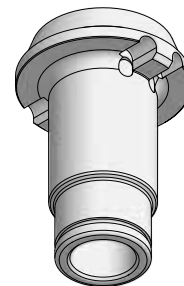
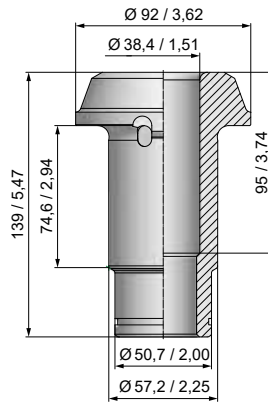
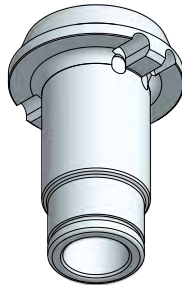
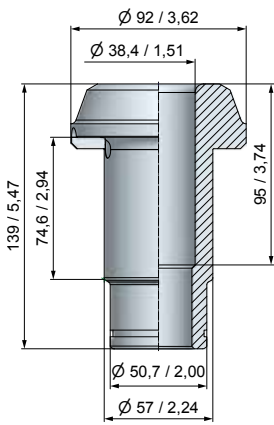

■ **BR76**
BR 57-38



■ **BR87**
BR 57-38/K



ROUND SHANK CUTTER BITS



▶ SHANK SYSTEM – Ø 38 MM/1,5"

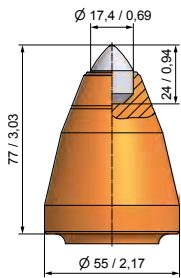

• **BSR286**
BG38K-17.5577A

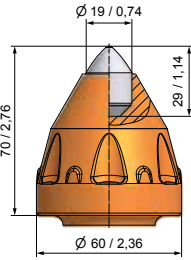

• **BSR188**
BG38K-19.6070

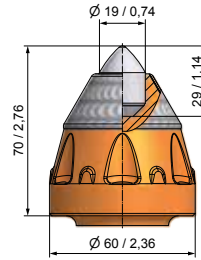

• **BSR202P**
BG38K-19.6070P

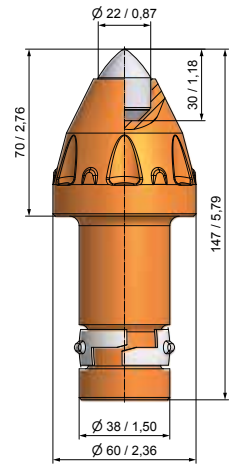

• **BSR189**
BG38K-22.6070

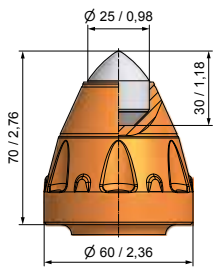

• **BSR190**
BG38K-25.6070

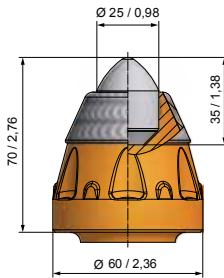

• **BSR190P2**
BG38K-25.6070P2

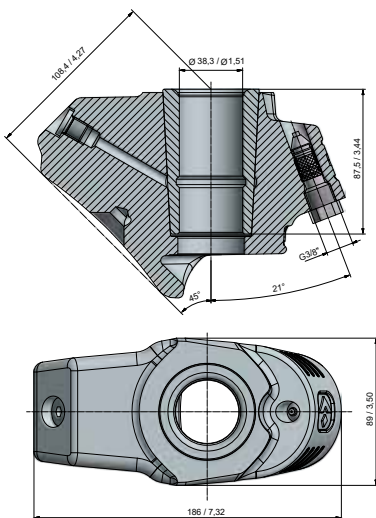

• **BHR222**
B38.8945-B

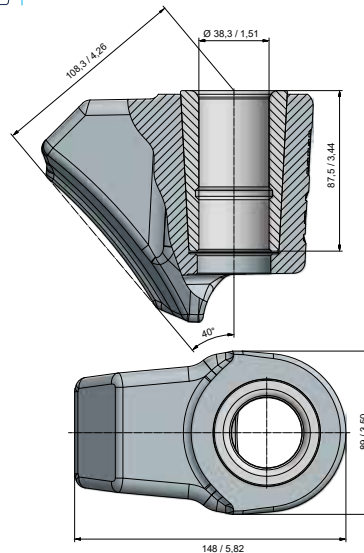
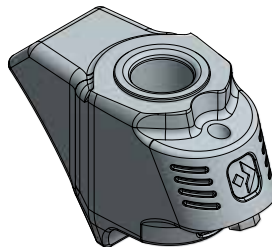

• **BHR219**
B38.8940

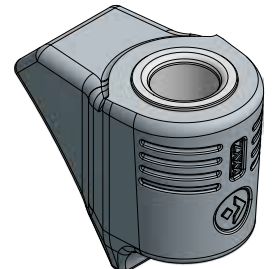



ROUND SHANK CUTTER BITS



▶ SHANK SYSTEM – Ø 38 MM/1,5" HOLDER LENGTH 65 MM/2,6"

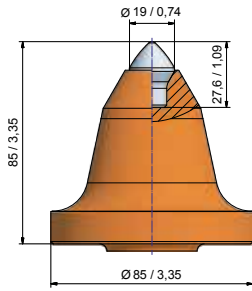

• **BSR441**
BG38W-72.8585

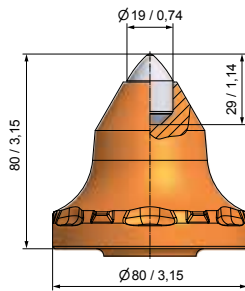

• **BSR311**
BG38W-19.8080

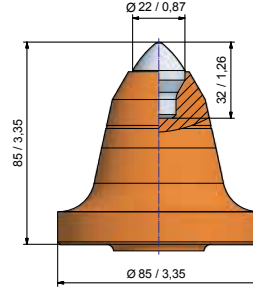

• **BSR452**
BG38W-73.8585

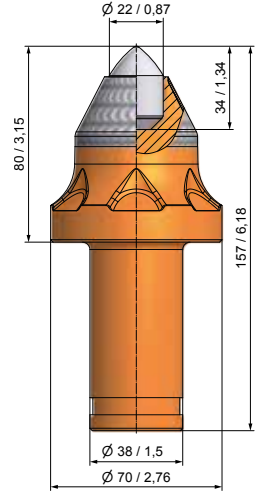

• **BSR199P**
BG38W-22.7080AP

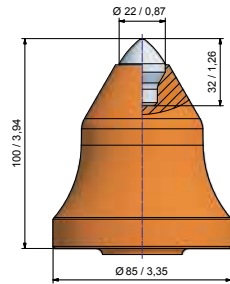

• **BSR436**
BG38W-73.85100

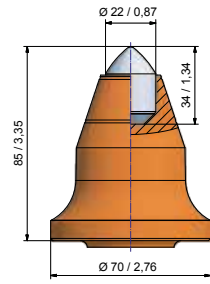

• **BSR379**
BG38W-22.7085

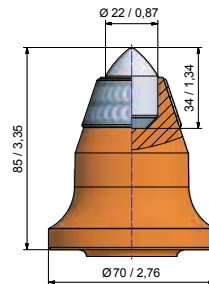

• **BSR379P**
BG38W-22.7085P

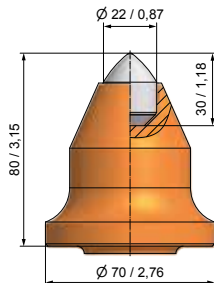

• **BSR140**
BG38W-22.7080

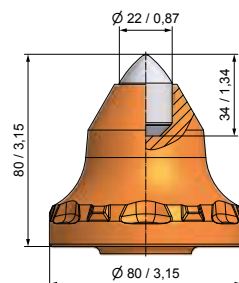

• **BSR198**
BG38W-22.8080A

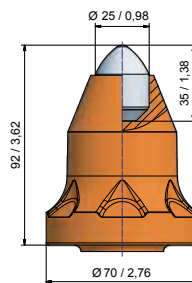

• **BSR444-A**
BG38W-25.7092

► SHANK SYSTEM – Ø 38 MM/1,5"
 HOLDER LENGTH 65 MM/2,6"

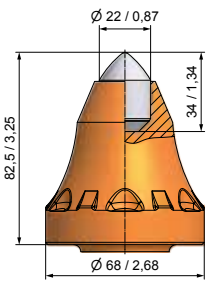

• **BSR237**
 BG38W-22.6883A

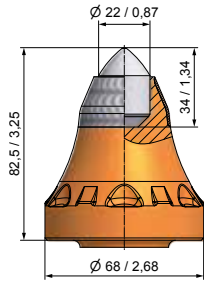

• **BSR240P**
 BG38W-22.6883PA

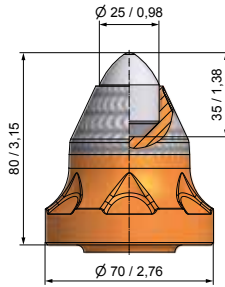

• **BSR200P**
 BG38W-25.7080P

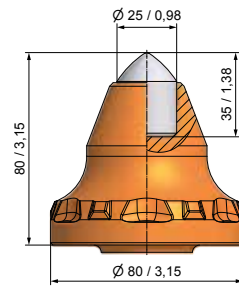

• **BSR201**
 BG38W-25.8080A

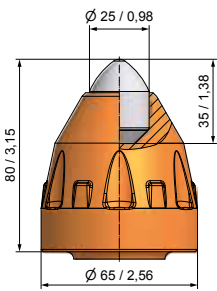

• **BSR312**
 BG38W-25.6580

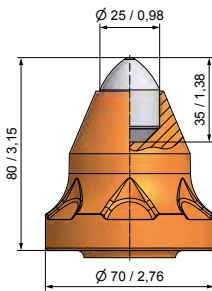

• **BSR287**
 BG38W-25.7080

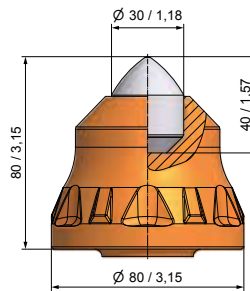

• **BSR197**
 BG38W-30.8080A

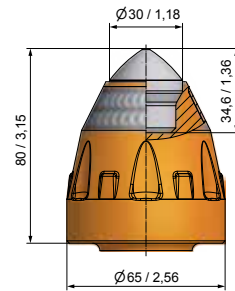

• **BSR338P**
 BG38W-75.6580PA

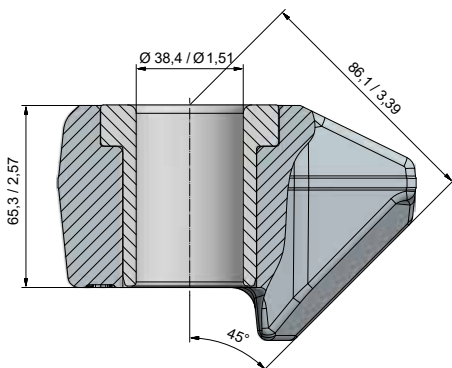

• **BHR169**
 B38H

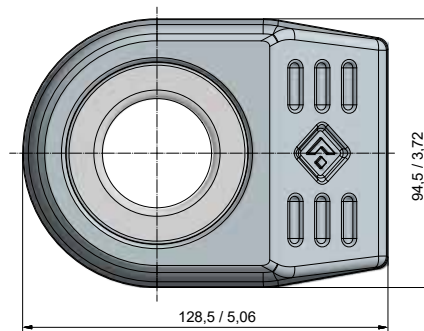

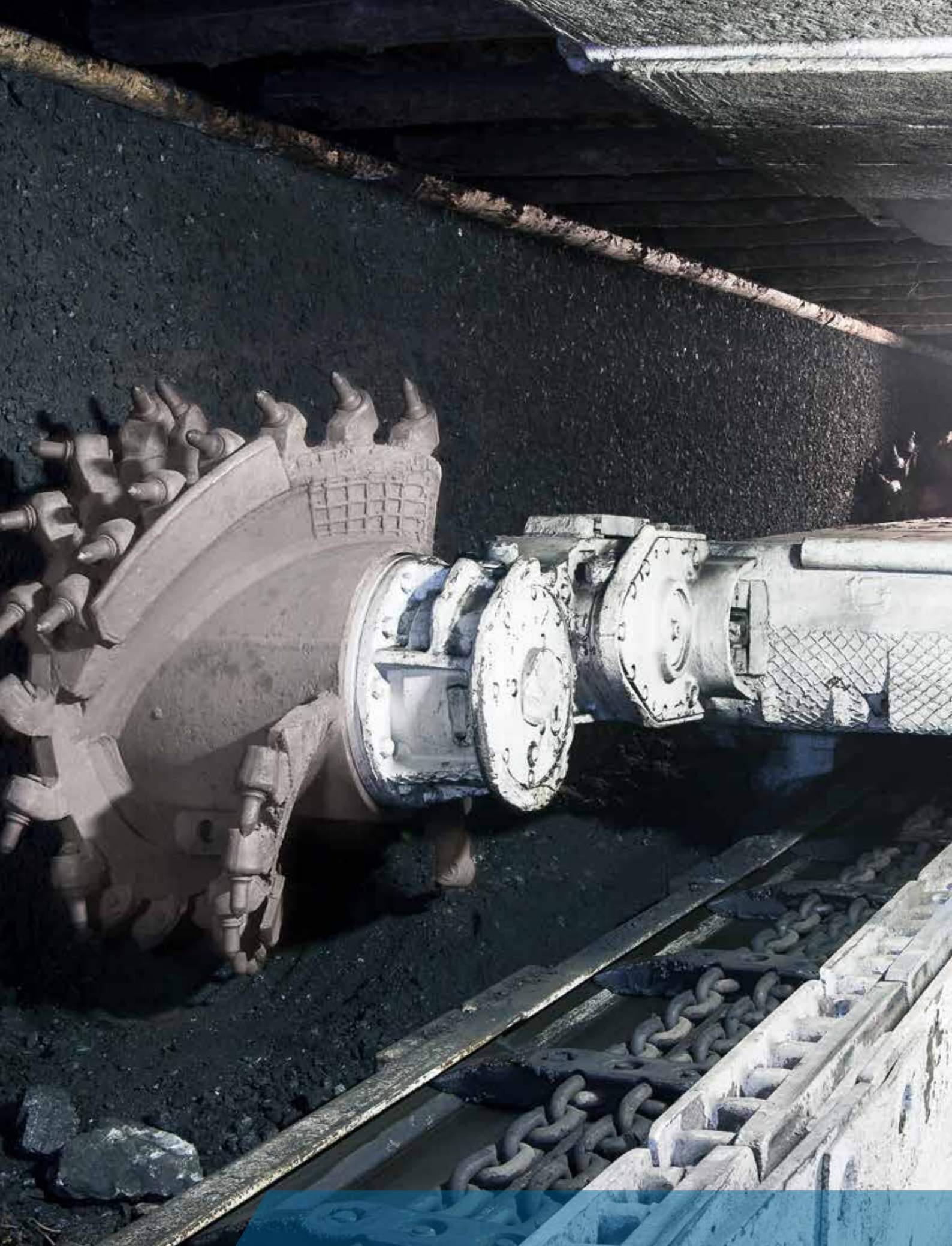

ROUND SHANK CUTTER BITS

► SHANK SYSTEM – Ø 38 MM/1,5"
HOLDER LENGTH 75 MM/3,0"

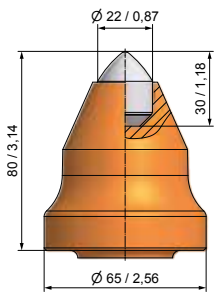

• **BSR114**
BG38W-22.6580

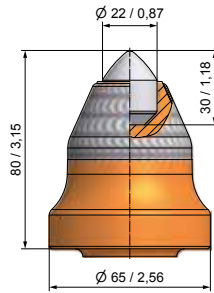

• **BSR131P**
BG38W-22.6580P

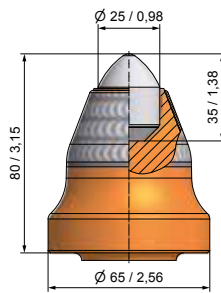

• **BSR215P**
BG38W-25.6580P

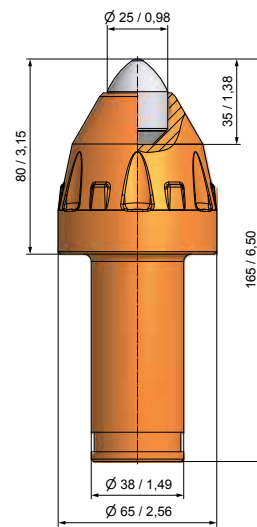

• **BSR193**
BG38W-25.6580



SPECIAL SHANK SYSTEM

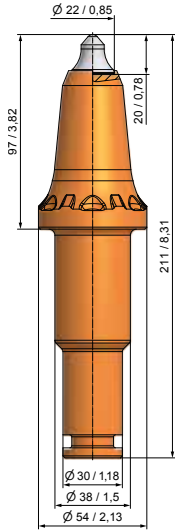

■ **BKFX23**
BS38F-67.5497

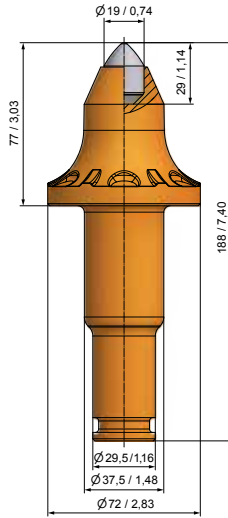

■ **BKFX57**
BS38F-19.7277

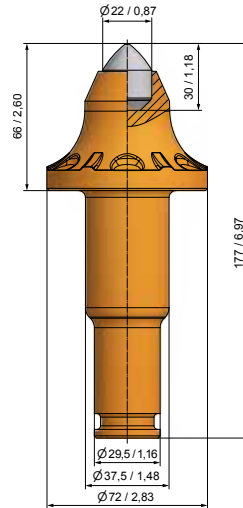

■ **BKFX58**
BS38F-22.7266

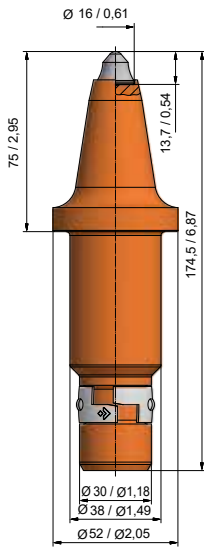

■ **BLK10**
BS38K-61.5275

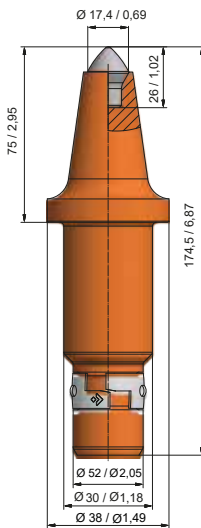

■ **BLK14**
BS38K-70.5275

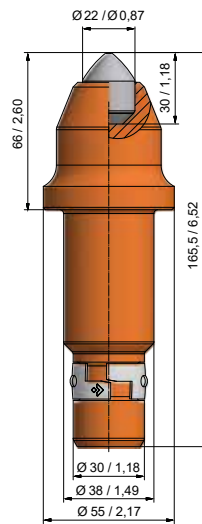

■ **BLK12**
BS38K-22.5566



SPECIAL SHANK SYSTEM

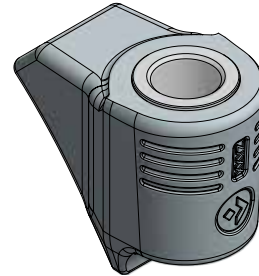
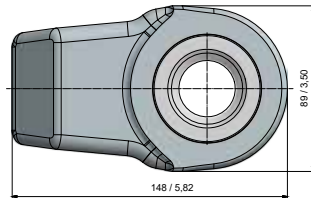
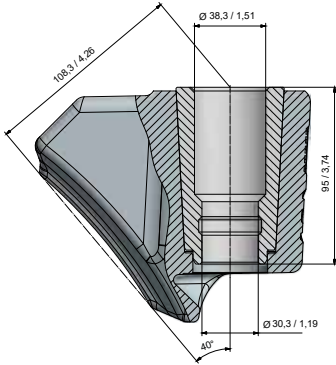

• **BHR191**
B3830.8940



ROUND SHANK CUTTER BITS

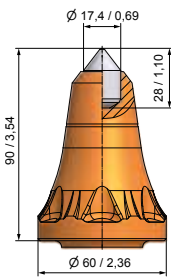

• **BKR27**
BG38X-17.6090

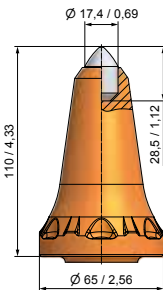

• **BKR33**
BG38X-17.65110

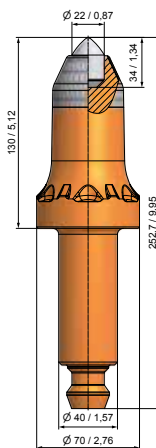

• **BKR30P**
BG40X-22.70130PA

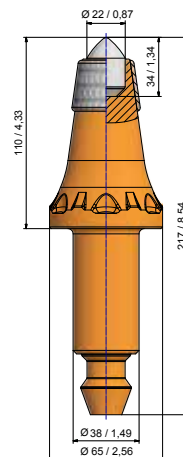

• **BKR31/2P**
BG38X-22.65110PB

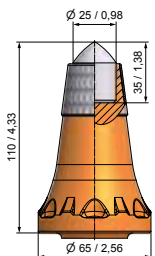

• **BKR32P**
BG38X-25.65110P





ROUND SHANK CUTTER BITS

► SHANK SYSTEM – Ø 43/35 MM-1,70/1,38"
GAUGE 102 MM/4,0" | 89 MM/3,5"

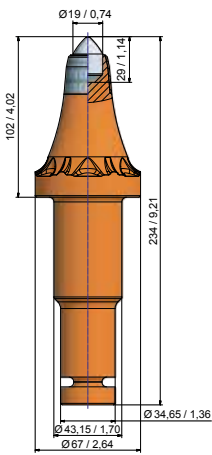

■ **BSR284P**
BS43X-19.67102P

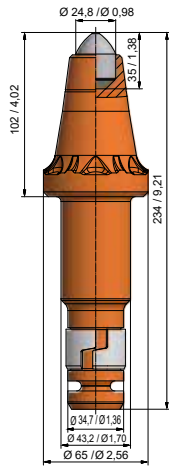

■ **BSR258/ DR**
BS43H-25.65102

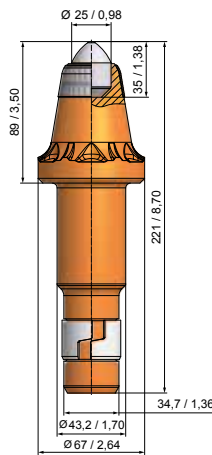

■ **BSR265P**
BS43H-25.6789P

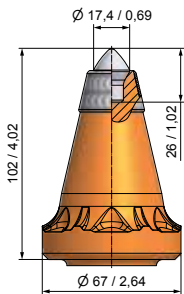

■ **BSR230P**
BS43H-70.67102P

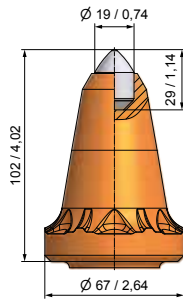

■ **BSR204**
BS43H-19.67102A

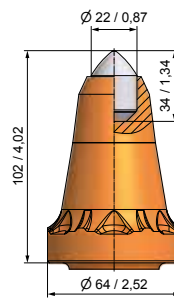

■ **BSR236**
BS43H-22.64102

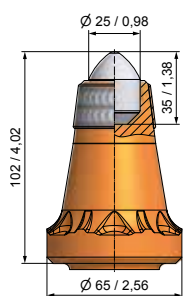

■ **BSR258P/ DR**
BS43HX-25.65102P

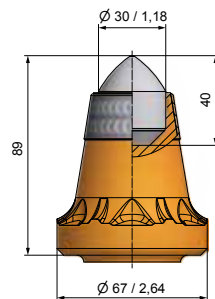

■ **BSR369P**
BS43H-30.6789P

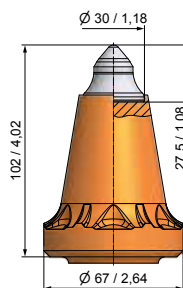

■ **BSR181**
BS43H-69.67102A



ROUND SHANK CUTTER BITS



► SHANK SYSTEM – Ø 43/35 MM-1,70/1,38" GAUGE 114 MM/4,5"

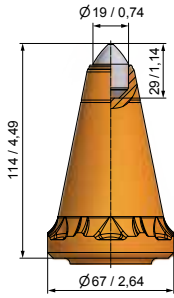

■ **BSR182**
BS43H-19.67114

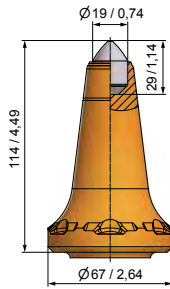

■ **BSR184S**
BS43H-19.67114S

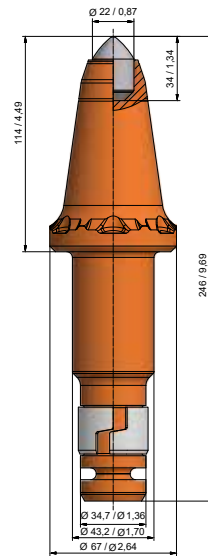

■ **BSR231/DR**
BS43HX-22.67114

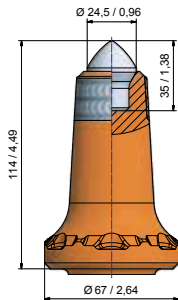

■ **BSR417P**
BS43H-71.67114P

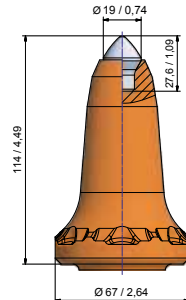

■ **BSR418**
BS43H-72.67114

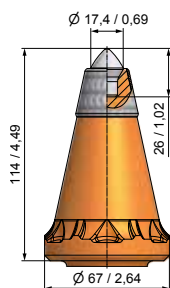

■ **BSR211P**
BS43H-70.67114AP

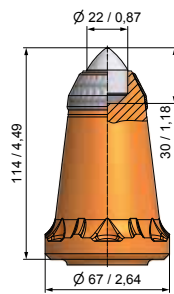

■ **BSR178P**
BS43H-22.67114P

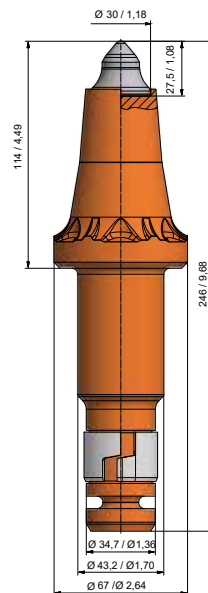

■ **BSR203/DR**
BS43H-67.67114

► SHANK SYSTEM – Ø 43/35 MM-1,70/1,38"

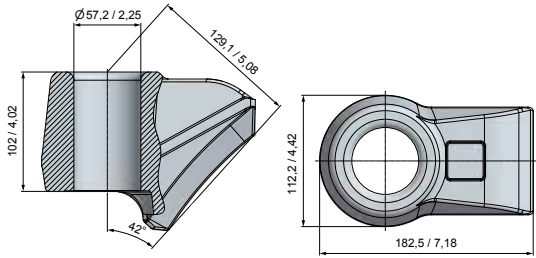

■ BHR261
B300

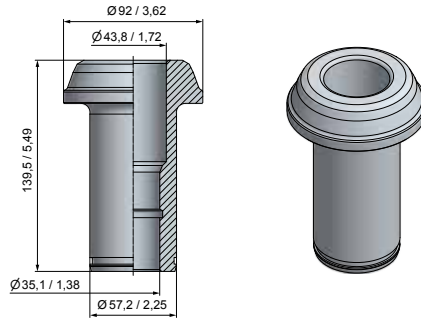

■ BR94
BR57-44A

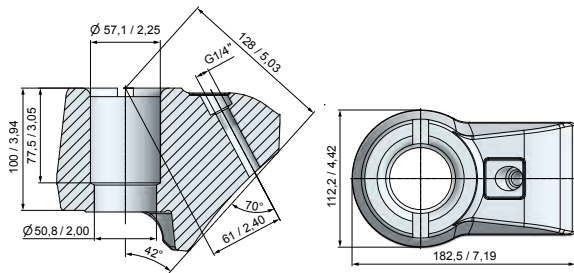

■ BHR159
B300

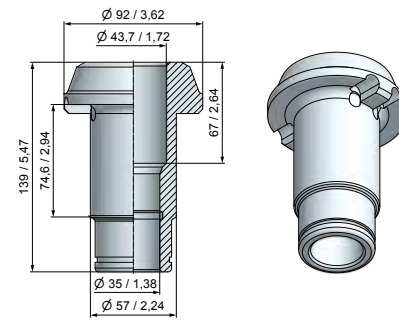

■ BR74
BR57-44

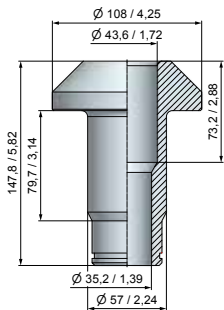

■ BR79
BR57-44-144

RADIAL BITS

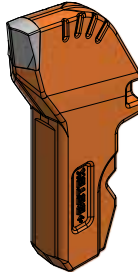
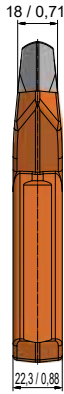
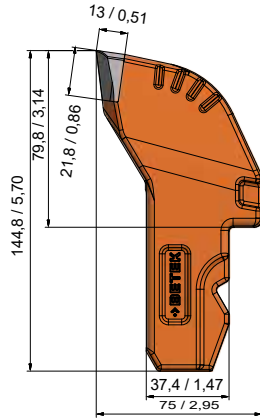

■ **BF56**
BF145x38x22/2

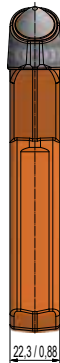
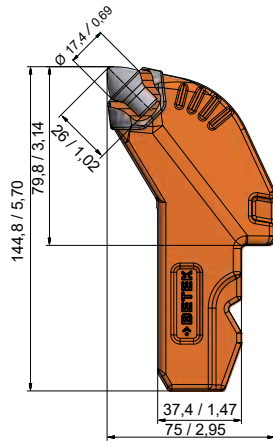

■ **BF57**
BF145x38x22/3P

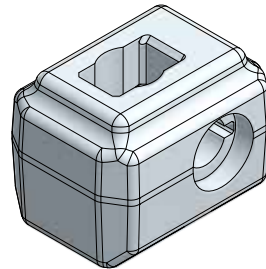
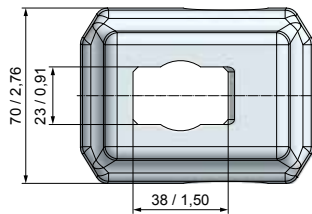
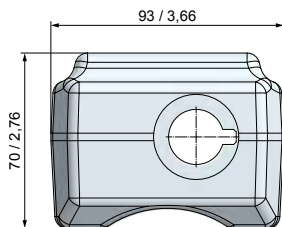

■ **BHF19**
BHF38x23



MINING

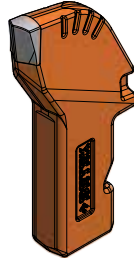
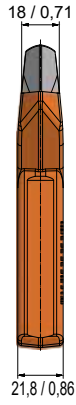
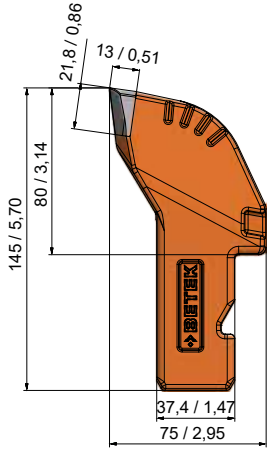

■ **BF58/3**
BF145x38x22/4 

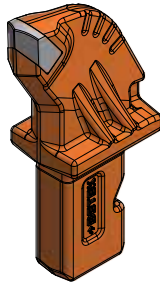
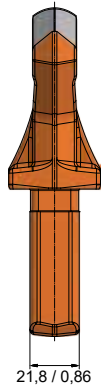
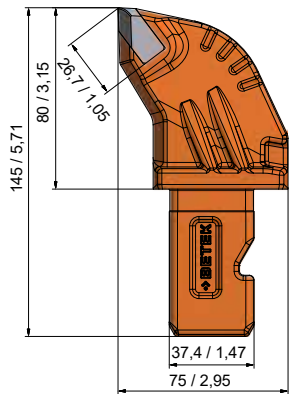

■ **BF66**
BF145x38x22/HD 

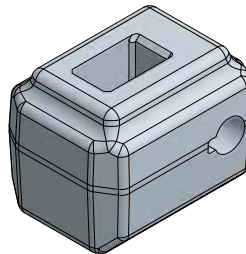
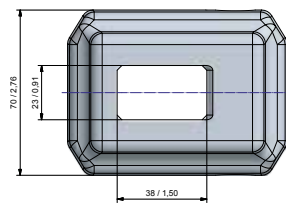
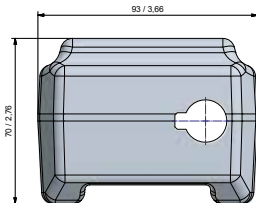

■ **BHF33**
BHF38x23/LR 

RADIAL BITS

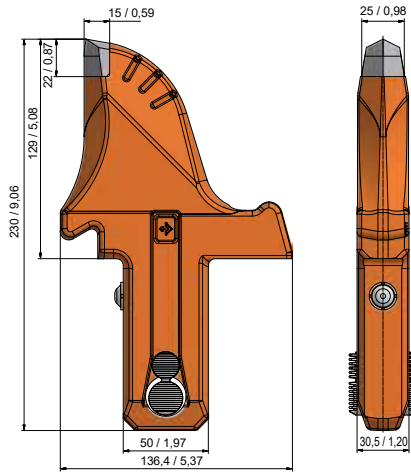

■ **BF38**
BF230x137x30.5

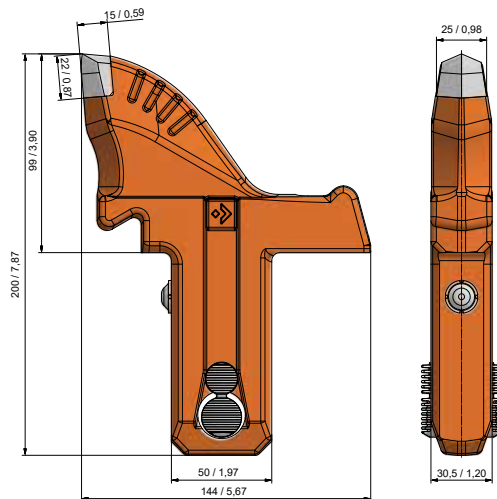

■ **BF45**
BF200x137x30.5

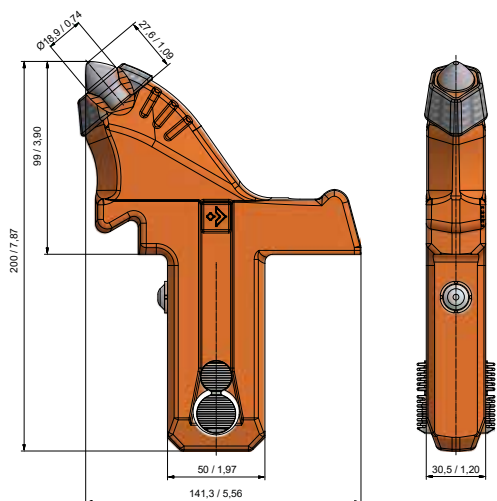

■ **BF65**
BF200x145x30.5P





ACCESSORIES



▪ **BZ44**
Bit extractor for Mini bit



▪ **BZ42**
Bit extractor for BSH on BC-Series



▪ **BZ43**
Bit extractor for BSH, BC and BSK-Series



▪ **BZ38**
Wedge puller for shaft diameter 20-25

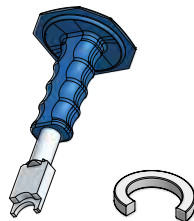

▪ **BZ33**
Assembly tool for SI36

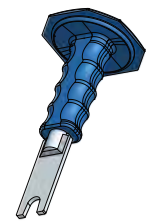

▪ **BZ31**
Disassembly tool for SI36



▪ **BZ41**
Assembly tool for SI26



▪ **BZ32**
Disassembly tool for SI26



▪ **BZ22**
Bit puller for BTK-Series



▪ **BZ37**
Assembly tool for SI216



▪ **BZ36**
Disassembly tool for SI216



▪ **BZ05**
Bit puller for head diameter 60



▪ **BZ35**
Assembly tool for SI239



▪ **BZ34**
Disassembly tool for SI239



▪ **BZ39**
Wedge puller for shaft diameter 30-38



▪ **SRZ02**
Plier for SR83/1, SR81, SR64, SR61, SR26 and SR54



▪ **BZ12**
Bit puller for BKH-Series



▪ **BZ18**
Bit puller with copper disk for BKH-Series



▪ **BZ16**
Bit extractor for Roll pin with diameter 10



▪ **BZ30**
Bit extractor for Roll pin with diameter 16



▪ **BZ40**
Wedge puller for stepshank 43/35

FLEXIBLE WEAR PROTECTION

BeCoat® HARDFACING TYPES

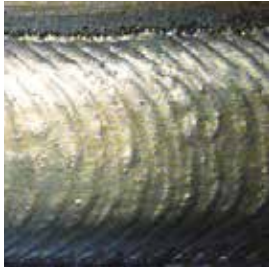

FeCr
hardfacing



NiCr + FTC
hardfacing



TC grit
hardfacing

BeCoat® ADVANTAGES

- Cost reduction due to less downtime
- Coating thickness ≤ 6mm
- Evenly distributed fused tungsten carbide (FTC) and low dilution
- Engineering and consulting
- Proven to withstand even the harshest environments

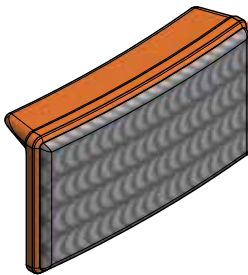

▪ **BA73**
BA 72x40x17

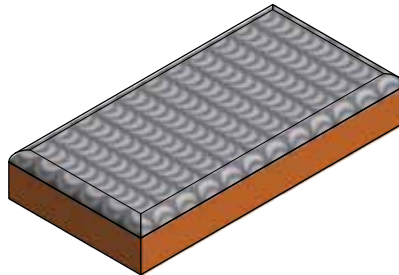

▪ **BBM386**
BBM 100x50x16

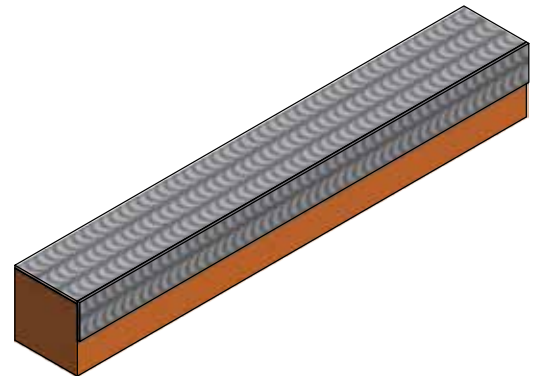

▪ **BBM391**
BBM 180x26x26

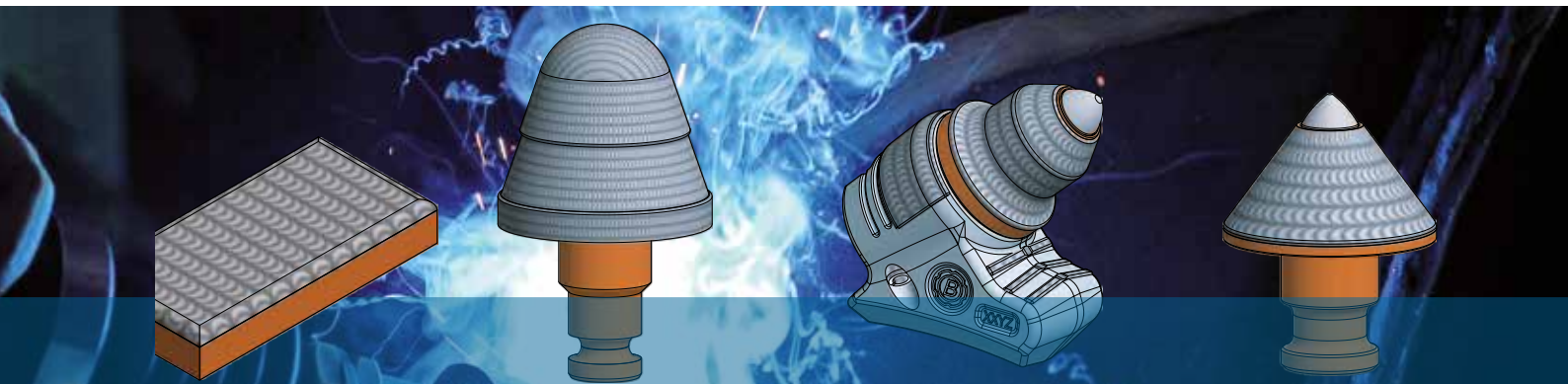

EXTENSIVE WEAR PROTECTION



► OVERVIEW

Betek can provide the appropriate stud welding machine for the TungStuds wear protection system.

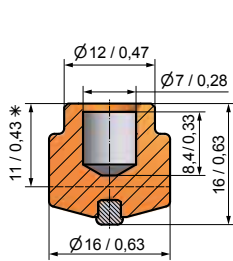

■ **BTS01** BTSD16/16 

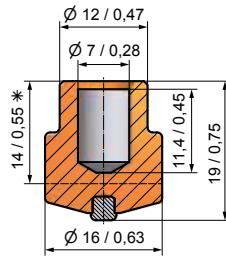

■ **BTS02** BTSD16/19 

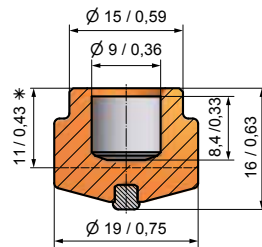

■ **BTS03** BTSD19/16 

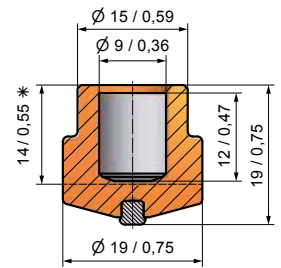

■ **BTS04** BTSD19/19 

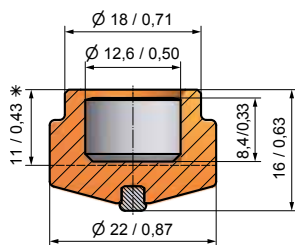

■ **BTS05** BTSD22/16 

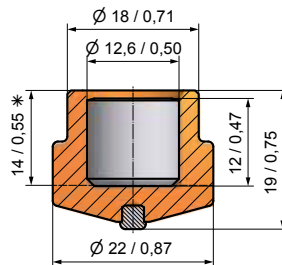

■ **BTS06** BTSD22/19 

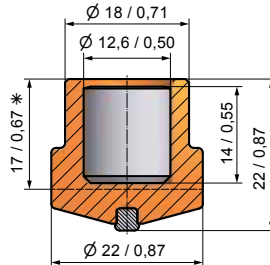

■ **BTS07** BTSD22/22 

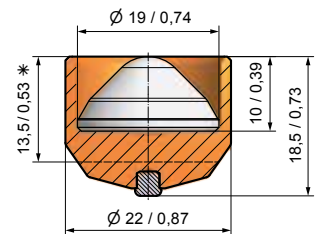

■ **BTS08** BTSD22/18,5SG 

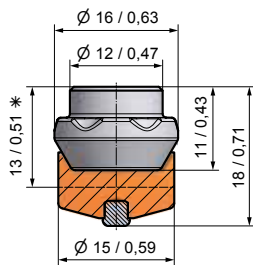

■ **BTS10B** BTSD16/18B 

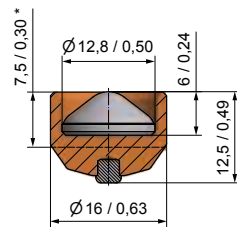

■ **BTS20** BTSD16/12,5SG 

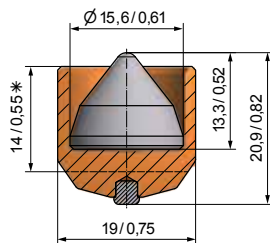

■ **BTS100** BTSD19/15,6SG 

*Height after welding

> **BTS-PLATES**

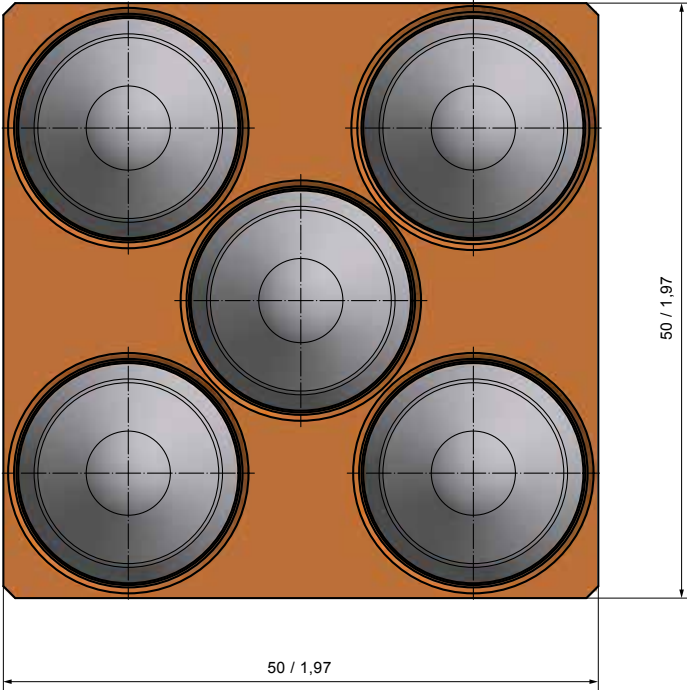
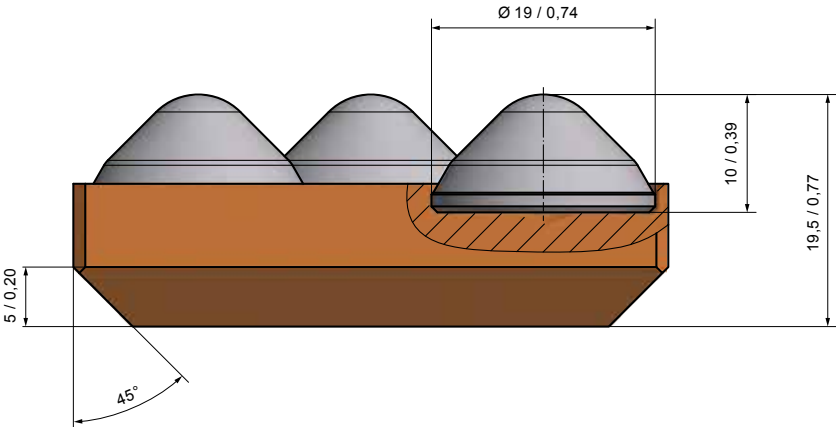

DIMENSIONS

Width in mm	Length in mm
50	50
75	75
100	100
125	125
150	150

Other sizes on request

EXTENSIVE WEAR PROTECTION

› WELDING PROCESS

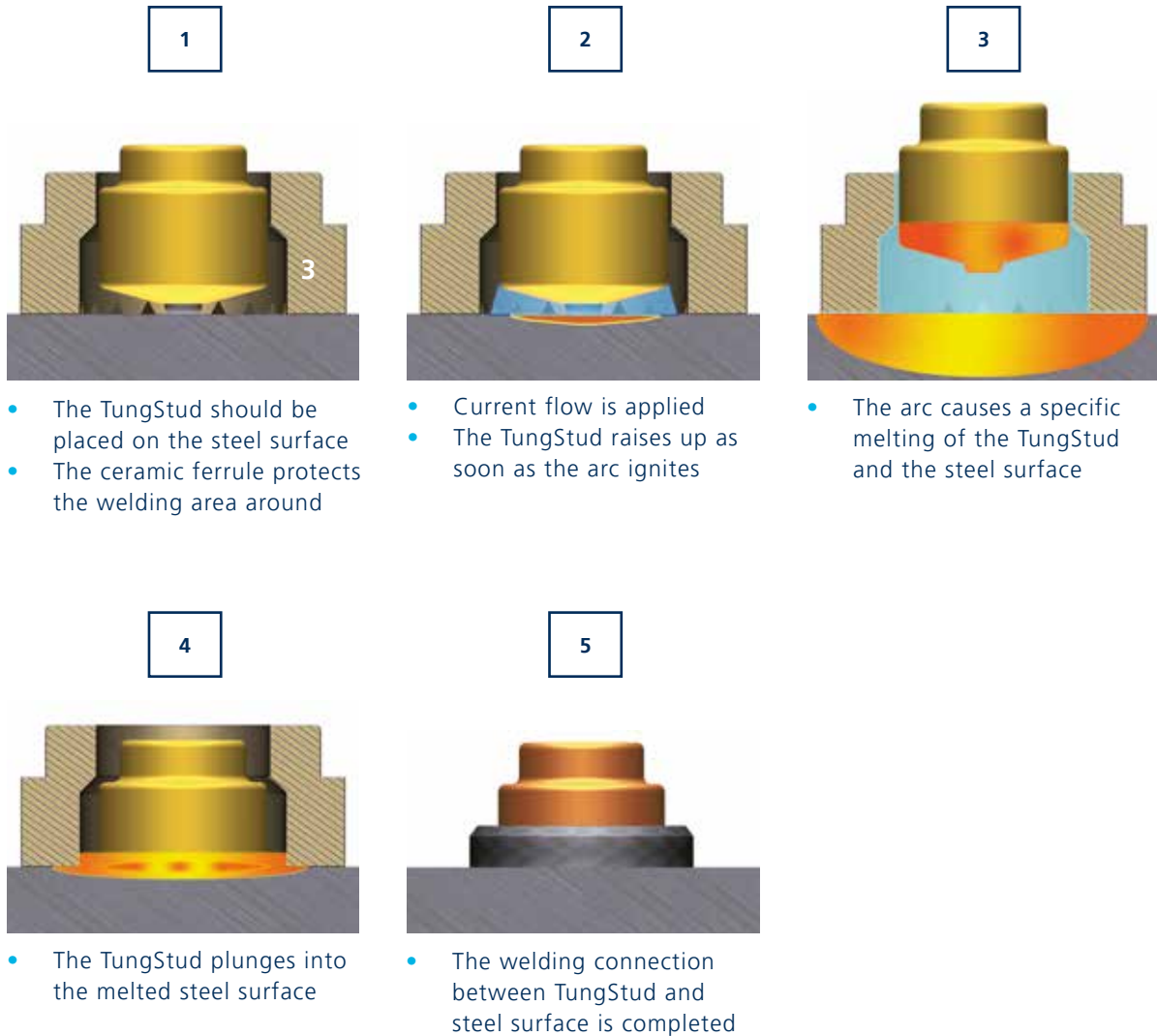

BENEFITS

- Wear resistant thanks to the carbide core
- Quick welding process
- Suitable for uneven surfaces
- Simply replaceable
- Less maintenance › Higher productivity
- Less downtime › Cost reduction

PERFORMANCE

› CUTTING WEAR PROTECTION

- Grid pattern is recommended
- Cutting wear protection due to the conical carbide shape

EXTENSIVE WEAR PROTECTION



› ROCK BOX EFFECT

- Grid pattern is recommended
- Rock-Box-Effect due to the cylindrical carbide shape

EXTENSIVE WEAR PROTECTION

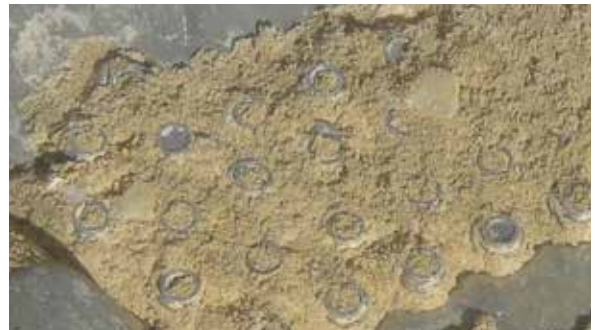

APPLICATION



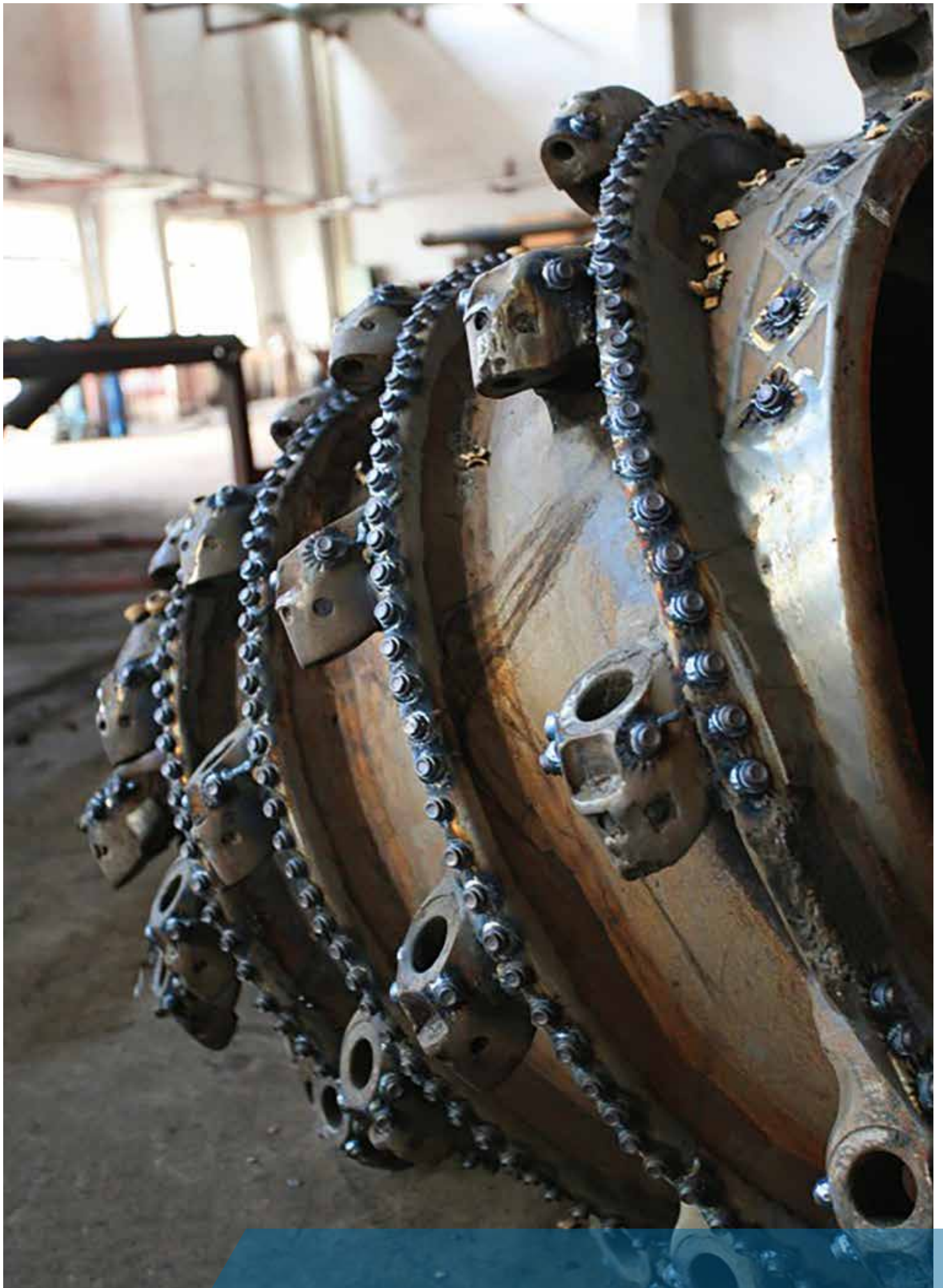









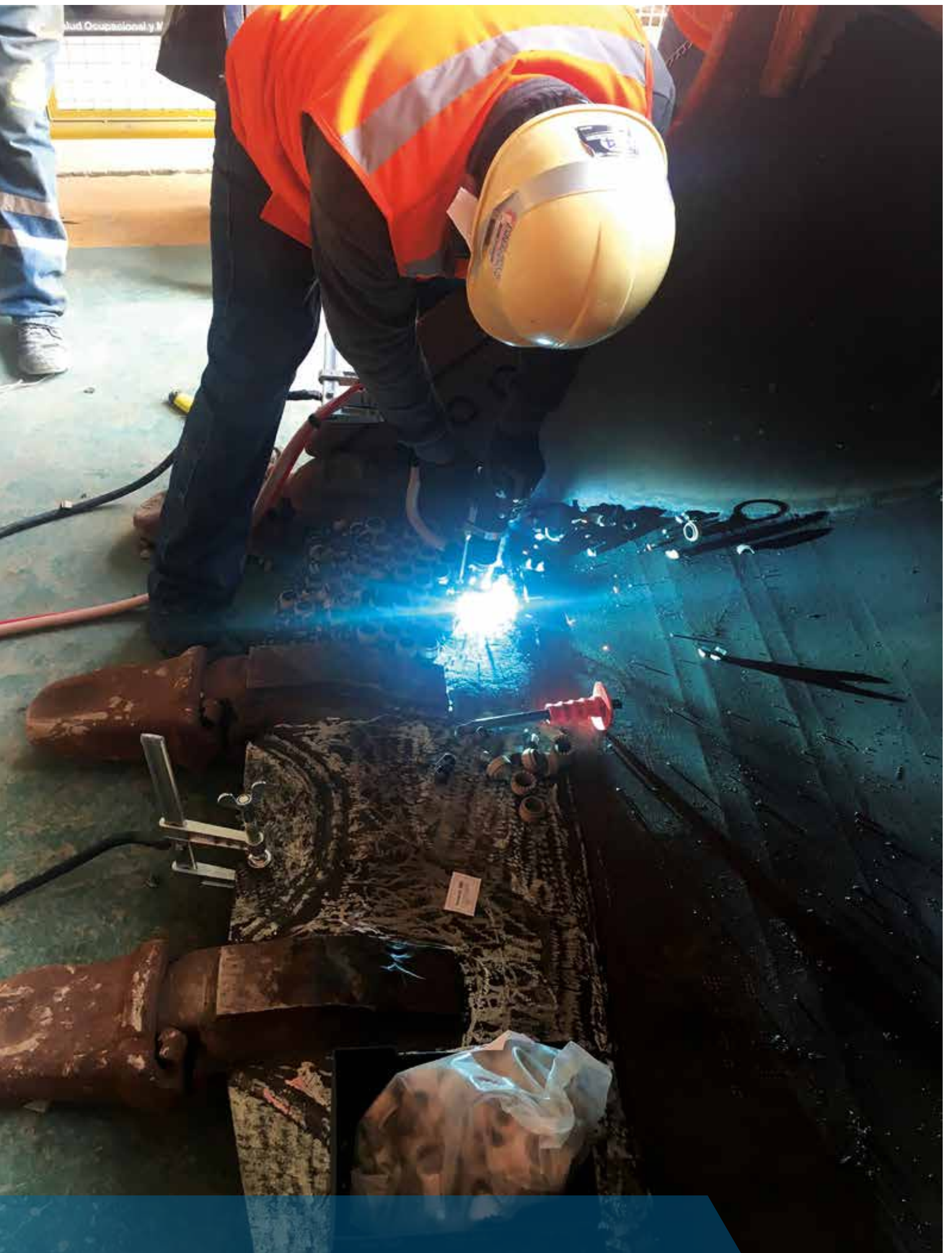

➤ BETEK

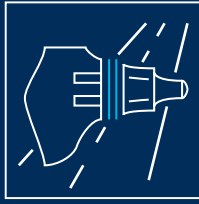

SURFACE TECHNOLOGIES

- ROAD MILLING
- SURFACE MINING
- STABILISING



UNDERGROUND TECHNOLOGIES

- FOUNDATION DRILLING
- MINING
- TRENCHLESS
- TRENCHING
- TUNGSTUDS
- DRUM CUTTERS

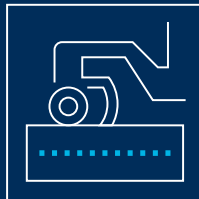

ENVIRONMENTAL TECHNOLOGIES

- AGRICULTURE
- GRADER TOOLS
- FORESTRY & RECYCLING



INDUSTRIAL TECHNOLOGIES

- CRUSHING & MIXING
- TUNGSTEN CARBIDE
- RAIL TRACK CONSTRUCTION
- INDUSTRIAL SOLUTIONS

Service number
+49 (0) 7422. 565-0

info@betek.de
www.betek.de